

DODGE COUNTY UTILITY INSTALLATION AGREEMENT  
Public Utilities

WITNESS, that this shall be an agreement between Dodge County, hereafter referred to as the County and Black Hills Gas Distr. LLC, hereafter referred to as the Applicant. Whereas, the County and Applicant do hereby agree,

1. THAT, The Applicant shall be permitted to install a 1" PE Natural Gas Line under, through, or aerial, the Public Right-of-Way of Dodge County.
2. THAT, the County and Townships are the owners and responsible for the Public Right-of-Way In the County and Applicant desires to install a Utility on Public Right-of-Way,
3. THAT, In consideration of this agreement, the County does hereby permit Applicant to lay, install, and construct said Utility In the Public Right-of-Way between Sec 4-9 (Description of Property or Sections) In T17N R6E Township, Dodge County, Nebraska.
4. THAT, the permit on the part of Dodge County is revocable at the will of the County, and Applicant agrees that upon written notice from the County Board of Supervisors, he will immediately and forthwith remove said Utility and any and all pipes or other material contained or used in connection with said Utility and return the roadway occupied by said Utility to substantially it's original condition as before installation of said Utility.
5. THAT, the Applicant shall notify the Highway Superintendent or local Township for the purpose of removing the gravel windrow to the opposite side of road so as not to lose any gravel in the open trench.
6. THAT, all backfill in the Public Right-of-Way proper shall be made with material excavated from the crossing or with material equivalent thereto in texture. Material shall be placed in six inch lifts for the full depth of the trench and compacted by tamping to the original cross section. All utilities placed in areas susceptible to erosion shall place adequate protection against erosion. This protection may include bale checks, silt fence and erosion blankets. All vegetation destroyed shall be replaced. Disturbed areas will be reseeded with native grasses and a starter fertilizer. The minimum depth of earth cover over the utility line shall be 3 feet. Installation of underground utility lines under the traveled portion of an existing county road way must be encased in a plastic or steel conduit. The casing shall be bored from the toe of the shoulder slope to the toe of the opposite shoulder slope. The utility shall be placed at a minimum depth of 3 feet below the bottom elevation of the parallel road ditch. Applicant and his contractor or subcontractors are responsible for temporary traffic control on Dodge County Right-of-Way based on the standards and guidelines found in Part 6 of the 2009 Edition of the Manual on Uniform Traffic Control Devices (MUTCD) to insure a safe work zone for the workers and the public. Applicant will provide all necessary signs, barricades, cones, flaggers and message boards.
7. THAT, the Applicant shall obtain approval of all County road restoration from the County Highway Superintendent or Township Official prior to leaving the site(s).
8. THAT, all backfilled area(s) disturbed by excavation and backfill operations shall be graded, hand dressed as required to restore the terrain to it's original shape, grade, and cross section, and regraded or reroaked at a rate of 150 tons per mile as directed by the County Highway Superintendent or Township Official.
9. THAT, the Applicant shall as directed by the County Highway Superintendent or Township Official remove at the Applicant's expense from the Public Right-of-Way all temporary structures, and waste materials resulting from their operations.
10. THAT, the Applicant shall file a scaled set of plans, showing the Utility route, depth, and distance from the section line with the Dodge County Highway Superintendent.
11. THAT, the Applicant shall when installing an aerial Utility, shall install such Utility one foot inside the Public Right-of-Way and at a minimum height of 18 feet above the traveled way.
12. THAT, the future maintenance of said Utility and reinstallation or reconstruction of same for any purpose whatsoever shall be borne by Applicant.
13. THAT, Applicant does hereby agree to hold the County or any of it's Officers, Agents, or Employees forever harmless of all liabilities due to improper installation, construction, and maintenance of said Utility.
14. THAT, the Applicant shall submit an Insurance Certificate verifying General Liability of \$1,000,000.00; Personal Injury of \$500,000.00; Product & Completed Operations Aggregate of \$1,000,000.00; Medical Expense (Any One Person) of \$5,000.00; Each Occurrence of \$500,000.00. Certificate to be filed with this application.

COPY

Approved 2/28/19  
Date 1-16-2019  
846

IN WITNESS WHEREOF, the parties aforesaid have hereto set their hand this 31 day of Dec 2018  
DS [Signature]  
Signature of Applicant

[Signature]  
Dodge County Highway Superintendent

Don Willets  
Address of Applicant

1-16-19  
Date Filed with Dodge County Board of Supervisors

Black Hills Energy  
3132 E 18th St  
Columbus, NE  
68601

2018 DEC 31 AM 10:19  
RECEIVED  
Dodge Co Highway Dept

\*Please see exhibits "A" attached hereto and made part hereof.

EXIHIBIT A

CROSSING COUNTY ROAD T  
BETWEEN SECTION 4, TOWNSHIP 17 NORTH, RANGE 6 EAST  
AND SECTION 9, TOWNSHIP 17 NORTH, RANGE 6 EAST  
DODGE COUNTY, NEBRASKA



DODGE COUNTY UTILITY INSTALLATION AGREEMENT  
Public Utilities

WITNESS, that this shall be an agreement between Dodge County, hereafter referred to as the County and Black Hills Gas Distr LLC, hereafter referred to as the Applicant. Whereas, the County and Applicant do hereby agree,



COPY

1. THAT, The Applicant shall be permitted to install a 1" PE Natural Gas Line under, through, or aerial, the Public Right-of-Way of Dodge County.
2. THAT, the County and Townships are the owners and responsible for the Public Right-of-Way in the County and Applicant desires to install a Utility on Public Right-of-Way.
3. THAT, in consideration of this agreement, the County does hereby permit Applicant to lay, install, and construct said Utility in the Public Right-of-Way between See 3 (Description of Property or Sections) in T17 N R5E Township, Dodge County, Nebraska.
4. THAT, the permit on the part of Dodge County is revocable at the will of the County, and Applicant agrees that upon written notice from the County Board of Supervisors, he will immediately and forthwith remove said Utility and any and all pipes or other material contained or used in connection with said Utility and return the roadway occupied by said Utility to substantially it's original condition as before installation of said Utility.
5. THAT, the Applicant shall notify the Highway Superintendent or local Township for the purpose of removing the gravel windrow to the opposite side of road so as not to lose any gravel in the open trench.
6. THAT, all backfill in the Public Right-of-Way proper shall be made with material excavated from the crossing or with material equivalent thereto in texture. Material shall be placed in six inch lifts for the full depth of the trench and compacted by tamping to the original cross section. All utilities placed in areas susceptible to erosion shall place adequate protection against erosion. This protection may include bale checks, silt fence and erosion blankets. All vegetation destroyed shall be replaced. Disturbed areas will be reseeded with native grasses and a starter fertilizer. The minimum depth of earth cover over the utility line shall be 3 feet. Installation of underground utility lines under the traveled portion of an existing county road way must be encased in a plastic or steel conduit. The casing shall be bored from the toe of the shoulder slope to the toe of the opposite shoulder slope. The utility shall be placed at a minimum depth of 3 feet below the bottom elevation of the parallel road ditch. Applicant and his contractor or subcontractors are responsible for temporary traffic control on Dodge County Right-of-Way based on the standards and guidelines found in Part 6 of the 2009 Edition of the Manual on Uniform Traffic Control Devices (MUTCD) to insure a safe work zone for the workers and the public. Applicant will provide all necessary signs, barricades, cones, flaggers and message boards.
7. THAT, the Applicant shall obtain approval of all County road restoration from the County Highway Superintendent or Township Official prior to leaving the site(s).
8. THAT, all backfilled area(s) disturbed by excavation and backfill operations shall be graded, hand dressed as required to restore the terrain to it's original shape, grade, and cross section, and regraded or reroaked at a rate of 150 tons per mile as directed by the County Highway Superintendent or Township Official.
9. THAT, the Applicant shall as directed by the County Highway Superintendent or Township Official remove at the Applicant's expense from the Public Right-of-Way all temporary structures, and waste materials resulting from their operations.
10. THAT, the Applicant shall file a scaled set of plans, showing the Utility route, depth, and distance from the section line with the Dodge County Highway Superintendent.
11. THAT, the Applicant shall when installing an aerial Utility, shall install such Utility one foot inside the Public Right-of-Way and at a minimum height of 18 feet above the traveled way.
12. THAT, the future maintenance of said Utility and reinstallation or reconstruction of same for any purpose whatsoever shall be borne by Applicant.
13. THAT, Applicant does hereby agree to hold the County or any of it's Officers, Agents, or Employees forever harmless of all liabilities due to improper installation, construction, and maintenance of said Utility.
14. THAT, the Applicant shall submit an Insurance Certificate verifying General Liability of \$1,000,000.00; Personal Injury of \$500,000.00; Product & Completed Operations Aggregate of \$1,000,000.00; Medical Expense (Any One Person) of \$5,000.00; Each Occurrence of \$500,000.00. Certificate to be filed with this application.

IN WITNESS WHEREOF, the parties aforesaid have hereunto set their hand this 31 day of Dec, 2018  
[Signature]  
Signature of Applicant [Signature]  
Dodge County Highway Superintendent

Dan Willets  
Address of Applicant  
Black Hills Energy  
3132 E 18th St  
Columbus, NE  
68601

1-16-19  
Date Filed with Dodge County Board of Supervisors

2018 DEC 31 AM 10:19  
RECEIVED  
Dodge Co Highway Dept

Please see exhibit "A" attached hereto and made part hereof.

EXIHIBIT A

OCCUPY COUNTY ROAD 5  
SECTION 3, TOWNSHIP 17 NORTH, RANGE 5 EAST  
DODGE COUNTY, NEBRASKA

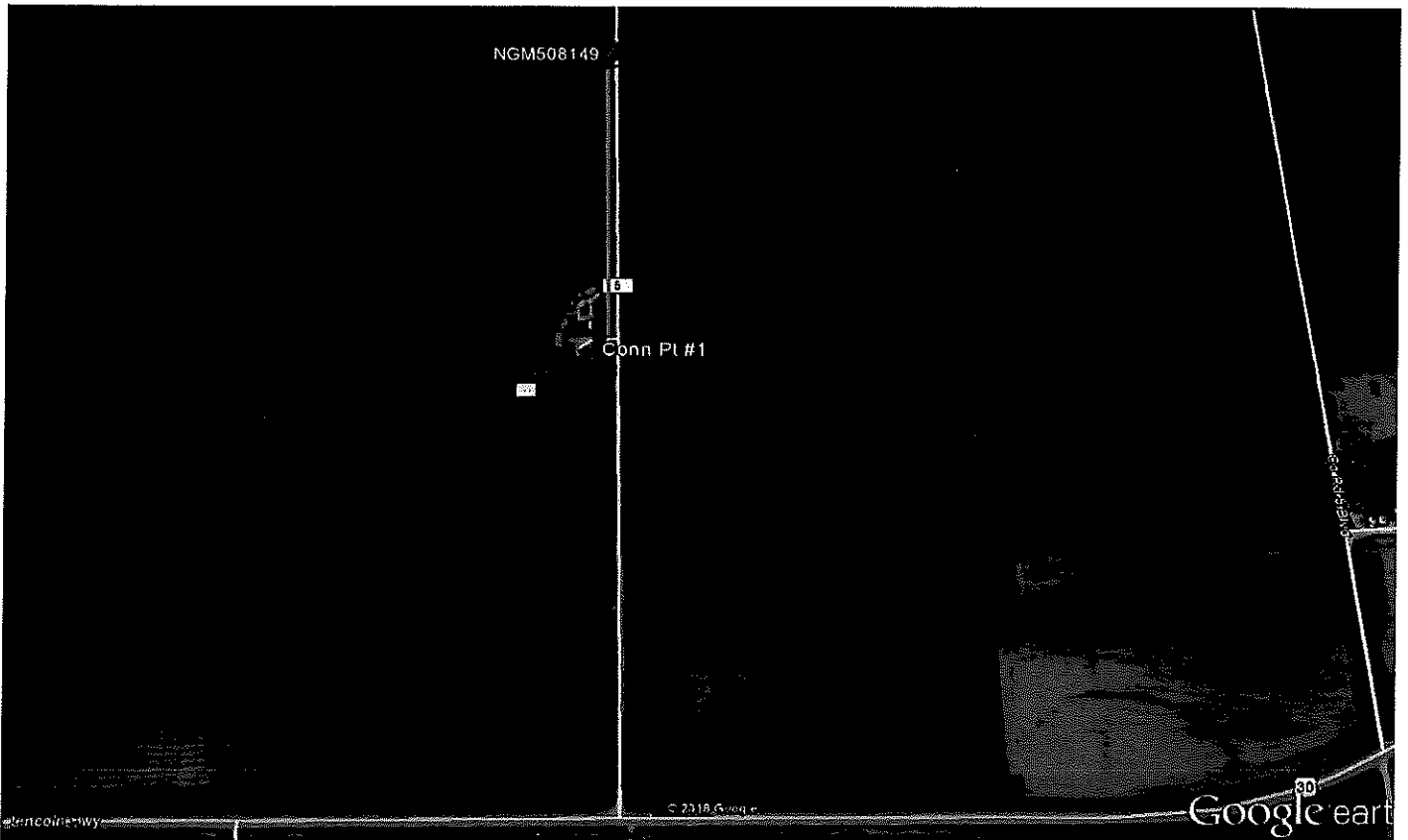

DODGE COUNTY UTILITY INSTALLATION AGREEMENT  
Public Utilities

WITNESS, that this shall be an agreement between Dodge County, hereafter referred to as the County and Black Hills Gas Distr LLC, hereafter referred to as the Applicant. Whereas, the County and Applicant do hereby agree,



COPY

- THAT, The Applicant shall be permitted to install a 1" PE Natural Gas LINE under, through, or aerial, the Public Right-of-Way of Dodge County.
- THAT, the County and Townships are the owners and responsible for the Public Right-of-Way in the County and Applicant desires to install a Utility on Public Right-of-Way.
- THAT, in consideration of this agreement, the County does hereby permit Applicant to lay, install, and construct said Utility in the Public Right-of-Way between NW 1/4 Sec 10 St 1/4 Sec 3 (Description of Property or Sections) in T 17N R 7E Township, Dodge County, Nebraska.
- THAT, the permit on the part of Dodge County is revocable at the will of the County, and Applicant agrees that upon written notice from the County Board of Supervisors, he will immediately and forthwith remove said Utility and any and all pipes or other material contained or used in connection with said Utility and return the roadway occupied by said Utility to substantially it's original condition as before installation of said Utility.
- THAT, the Applicant shall notify the Highway Superintendent or local Township for the purpose of removing the gravel windrow to the opposite side of road so as not to lose any gravel in the open trench.
- THAT, all backfill in the Public Right-of-Way proper shall be made with material excavated from the crossing or with material equivalent thereto in texture. Material shall be placed in six inch lifts for the full depth of the trench and compacted by tamping to the original cross section. All utilities placed in areas susceptible to erosion shall place adequate protection against erosion. This protection may include bale checks, silt fence and erosion blankets. All vegetation destroyed shall be replaced. Disturbed areas will be reseeded with native grasses and a starter fertilizer. The minimum depth of earth cover over the utility line shall be 3 feet. Installation of underground utility lines under the traveled portion of an existing county road way must be encased in a plastic or steel conduit. The casing shall be bored from the toe of the shoulder slope to the toe of the opposite shoulder slope. The utility shall be placed at a minimum depth of 3 feet below the bottom elevation of the parallel road ditch. Applicant and his contractor or subcontractors are responsible for temporary traffic control on Dodge County Right-of-Way based on the standards and guidelines found in Part 6 of the 2009 Edition of the Manual on Uniform Traffic Control Devices (MUTCD) to insure a safe work zone for the workers and the public. Applicant will provide all necessary signs, barricades, cones, flaggers and message boards.
- THAT, the Applicant shall obtain approval of all County road restoration from the County Highway Superintendent or Township Official prior to leaving the site(s).
- THAT, all backfilled area(s) disturbed by excavation and backfill operations shall be graded, hand dressed as required to restore the terrain to it's original shape, grade, and cross section, and regraded or rocked at a rate of 150 tons per mile as directed by the County Highway Superintendent or Township Official.
- THAT, the Applicant shall as directed by the County Highway Superintendent or Township Official remove at the Applicant's expense from the Public Right-of-Way all temporary structures, and waste materials resulting from their operations.
- THAT, the Applicant shall file a scaled set of plans, showing the Utility route, depth, and distance from the section line with the Dodge County Highway Superintendent.
- THAT, the Applicant shall when installing an aerial Utility, shall install such Utility one foot inside the Public Right-of-Way and at a minimum height of 18 feet above the traveled way.
- THAT, the future maintenance of said Utility and reinstallation or reconstruction of same for any purpose whatsoever shall be borne by Applicant.
- THAT, Applicant does hereby agree to hold the County or any of it's Officers, Agents, or Employees forever harmless of all liabilities due to improper installation, construction, and maintenance of said Utility.
- THAT, the Applicant shall submit an Insurance Certificate verifying General Liability of \$1,000,000.00; Personal Injury of \$500,000.00; Product & Completed Operations Aggregate of \$1,000,000.00; Medical Expense (Any One Person) of \$5,000.00; Each Occurrence of \$500,000.00. Certificate to be filed with this application.

IN WITNESS WHEREOF, the parties aforesaid have hereto set their hand this 31 day of Dec, 2018.

Den Willets  
Signature of Applicant

Den Willets  
Address of Applicant  
Black Hills Energy  
3132 E 18th St  
Columbus, NE  
68601

[Signature]  
Dodge County Highway Superintendent

1-16-19  
Date Filed with Dodge County Board of Supervisors

2018 DEC 31 AM 10:19  
RECEIVED  
Dodge Co Hwyway Dept

\*Please see exhibit "A" attached hereto and made part hereof.

# EXIHIBIT A

CROSSING COUNTY ROAD T  
BETWEEN SECTION 3, TOWNSHIP 17 NORTH, RANGE 7 EAST  
AND SECTION 10, TOWNSHIP 17 NORTH, RANGE 7 EAST  
DODGE COUNTY, NEBRASKA

