

Agenda Item # 226  
Date 11/16/22  
OPPD APPL #2711 WJO #12638201  
COJ ENGR BENITE  
COPY

**DODGE COUNTY UTILITY INSTALLATION AGREEMENT**  
**Public Utilities**

WITNESS, that this shall be an agreement between Dodge County, hereafter referred to as the County and OMAHA PUBLIC POWER DISTRICT, hereafter referred to as the Applicant. Whereas, the County and Applicant do hereby agree,

1. THAT, the Applicant shall be permitted to install an underground electric distribution line under, the Public Right-of-Way of Dodge County.
2. THAT, the County and Townships are the owners and responsible for the Public Right-of-Way in the County and Applicant desires to install a Utility on Public Right-of-Way.
3. THAT, in consideration of this agreement, the County does hereby permit Applicant to lay, install and construct said Utility in the Public Right-of-Way between NE COR SEC 07 T-19-N, R-09-E TO ~1700' West to OPPD customer (Description of Property or Sections) in NE COR SEC 07 T-19-N, R-09-E Township, Dodge County, Nebraska.
4. THAT, the permit on the part of Dodge County is revocable at the will of the County, and Applicant agrees that upon written notice from the County Board of Supervisors, he will immediately and forthwith remove said Utility and any and all pipes or other material contained or used in connection with said Utility and return the roadway occupied by said Utility to substantially it's original condition as before installation of said Utility.
5. THAT, the Applicant shall notify the Highway Superintendent and local Township for the purpose of removing the gravel windrow to the opposite side of road so as not to lose any gravel in the open trench.
6. THAT, all backfill in the Public Right-of-Way proper shall be made with material excavated from the crossing or with material equivalent thereto in texture. Material shall be placed in six inch lifts for the full depth of the trench and compacted by tamping to the original cross section. All utilities placed in areas susceptible to erosion shall place adequate protection against erosion. This protection may include bale checks, silt fence and erosion blankets. All vegetation destroyed shall be replaced. Disturbed areas will be reseeded with native grasses and a starter fertilizer. The minimum depth of earth cover over the utility line shall be 3 feet. Installation of underground utility lines under the traveled portion of an existing county road way must be encased in a plastic or steel conduit. The casing shall be bored from the toe of the shoulder slope to the toe of the opposite shoulder slope. The utility shall be placed at a minimum depth of 3 feet below the bottom elevation of the parallel road ditch. Applicant and his contractor or subcontractors are responsible for temporary traffic control on Dodge County Right-of-Way based on the standards and guidelines found in Part 6 of the 2009 Edition of the Manual on Uniform Traffic Control Devices (MUTCD) to insure a safe work zone for the workers and the public. Applicant will provide all necessary signs, barricades, cones, flaggers and message boards.
7. THAT, the Applicant shall obtain approval of all County road restoration from the County Highway Superintendent or Township Official prior to leaving the site(s).
8. THAT, all backfilled area(s) disturbed by excavation and backfill operations shall be graded, hand dressed as required to restore the terrain to its original shape, grade, and cross section, and regraded or rerocked at a rate of 150 tons per mile as directed by the County Highway Superintendent or Township Official.
9. THAT, the Applicant shall as directed by the County Highway Superintendent or Township Official remove at the Applicant's expense from the Public Right-of-Way all temporary structures, and waste materials resulting from their operations.
10. THAT, the Applicant shall file a scaled set of plans, showing the Utility route, depth, and distance from the section line with the Dodge County Highway Superintendent.
11. THAT, the Applicant shall when installing an aerial Utility, shall install such Utility one foot inside the Public Right-of-Way and at a minimum height of 18 feet above the traveled way.
12. THAT, the future maintenance of said Utility and reinstallation or reconstruction of same for any purpose whatsoever shall be borne by Applicant.
13. THAT, Applicant does hereby agree to hold the County or any of its Officers, Agents, or Employees forever harmless of all liabilities due to improper installation, construction, and maintenance of said Utility.
14. THAT, the Applicant shall submit an Insurance Certificate verifying General Liability of \$1,000,000.00; Personal Injury of \$500,000.00; Product & Completed Operations Aggregate of \$1,000,000.00; Medical Expense (Any One Person) of \$5,000.00; Each Occurrence of \$500,000.00. Certificate to be filed with this application.
15. THAT, this permit is valid for 6 months from the date of issuance or reapplication is required to renew.

IN WITNESS WHEREOF, the parties aforesaid have hereto set their hand this 28 day of October, 2022

DocuSigned by:  
Sharyl L McGuire  
Signature of Applicant

[Signature]  
Dodge County Highway Superintendent

OMAHA PUBLIC POWER DISTRICT  
ATTN: ALYSSA BRYANT, 6E/EP3  
444 S 16TH ST MALL  
OMAHA, NE 68102-2247  
Address of Applicant

11-16-22  
Date Filed with Dodge County Board of Supervisors

2022 OCT 31 AM 7:46  
RECEIVED  
Dodge County Highway Dept

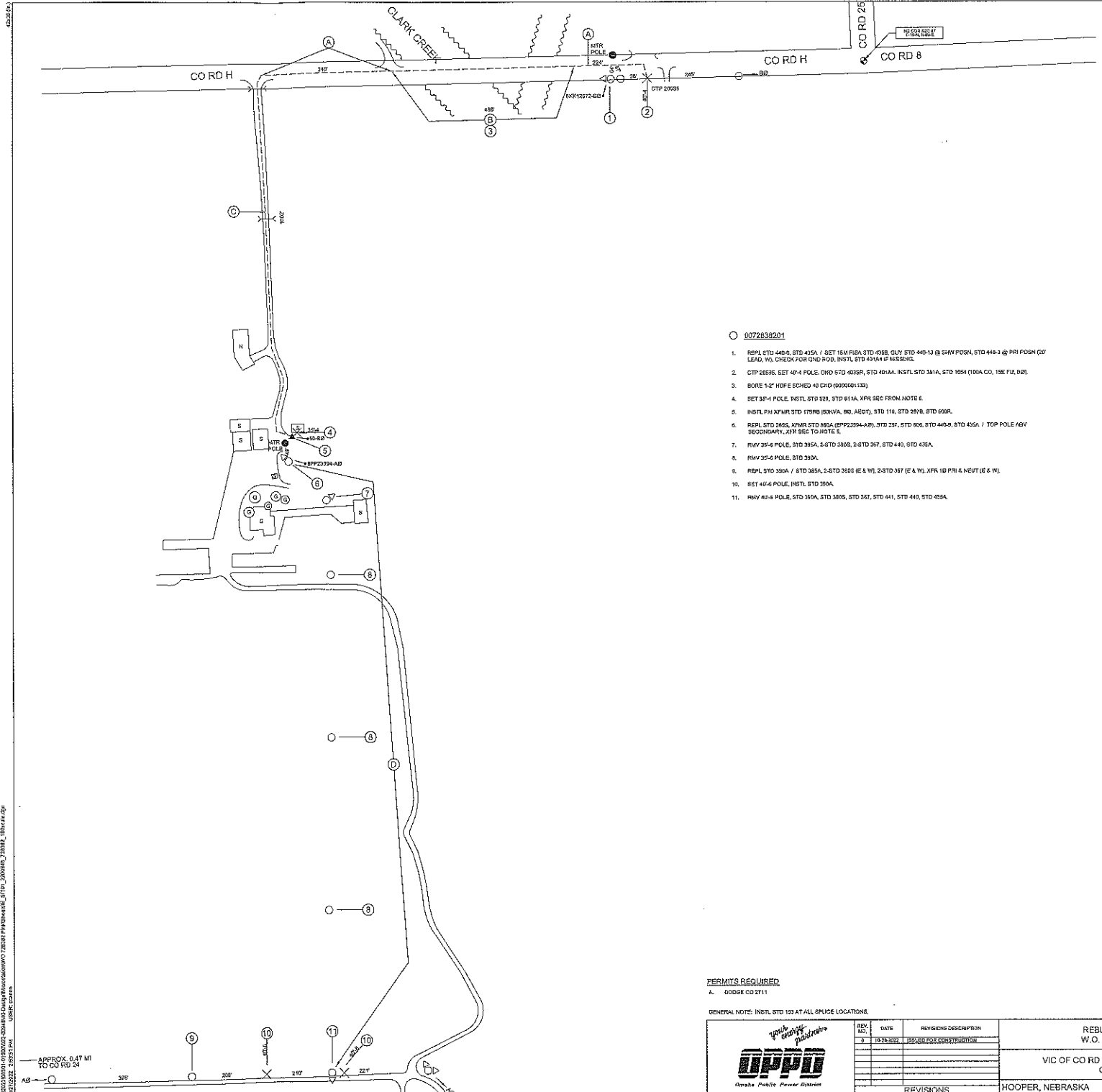

0072838201

1. REPL STD 440-6, STD 425A / SET 15M PISA STD 438B, GUY STD 440-13 @ SHV POSN, STD 444-3 @ PRI POSN (2' LEAD, W). CHECK FOR EXIST POLE, INSTL STD 401M (E NEISSIG).
2. DTP 20099, SET 4"-4 POLE, DND STD 4039R, STD 401M, INSTL STD 351A, STD 1054 (100A CO, 150 FUL, DGT).
3. BORE 1-2" HRF E SCHED 40 CHD (0000001133).
4. SET 30'-4 POLE, INSTL STD 328, STD 611A, XPR SEC FROM NODE 6.
5. INSTL PH XPR STD 175RB (BKVA, 80, A80T), STD 119, STD 307B, STD 698R.
6. REPL STD 365S, XPR STD 850A (PPP22094-AB), STD 237, STD 856, STD 440-9, STD 425A / TOP POLE ABV SECONDARY, XPR SEC TO NODE 6.
7. RHY 30'-6 POLE, STD 365A, 2-STD 350B, 2-STD 307, STD 440, STD 425A.
8. RHY 30'-6 POLE, STD 380A.
9. REPL STD 365A / STD 385A, 2-STD 382S (E & W), 2-STD 307 (E & W), XPR 10 PRI & NEUT (E & W).
10. SET 40'-6 POLE, INSTL STD 380A.
11. RHY 40'-6 POLE, STD 380A, STD 387, STD 441, STD 410, STD 425A.

CONDUCTOR NOTES

- A. FLOW 1-#10 AL 15KV XLP JKT 10 PRI CA (0000000319).
- B. FULL 1-#10 AL 15KV XLP JKT 10 PRI CA (0000000349).
- C. BORE 1-#10 AL 15KV XLP JKT 10 PRI CA (0000000349).
- D. RHY 2-#12 SCP 10 8KV PRI & NEUT.

PERMITS REQUIRED

- A. GDDGE CO 2711

GENERAL NOTE: INSTL STD 123 AT ALL SPULCE LOCATIONS.

REV NO	DATE	REVISIONS DESCRIPTION
1	10/26/2022	REBUILD FOR CONSTRUCTION

REBUILD 10 PRI  
W.O. 00728382-01  
VIC OF CO RD H & COUNTY LINE RD  
CKT 224  
HOOPER, NEBRASKA  
SKE-22-1353  
2022

**olsson**  
Nebraska Certificate of Authority #CA-0638  
601 P Street, Suite 200  
P.O. Box 84808  
Lincoln, NE 68508  
TEL 402.474.6311  
FAX 402.474.5180  
www.olsson.com

Drawn by: JMS  
Checked by: JMS  
Approved by: JMS  
Date: 10/26/22  
Project no.: 00728382  
Drawing no.: 00728382

SHEET  
1 OF 1

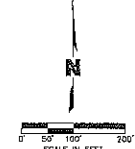

C:\Users\jms\OneDrive\Documents\Projects\00728382\00728382.dwg  
10/26/22 10:52:51 AM  
USER: jms