

**COPY**

**DODGE COUNTY UTILITY INSTALLATION AGREEMENT  
Public Utilities**

WITNESSETH that this shall be an agreement between Dodge County, hereafter referred to as the County and OMAHA PUBLIC POWER DISTRICT, hereafter referred to as the Applicant. Whereas, the County and Applicant do hereby agree,

1. THAT, the Applicant shall be permitted to install a underground primary cable, through, or aerial, the Public Right-of-Way of Dodge County.
2. THAT, the County and Townships are the owners and responsible for the Public Right-of-Way in the County and Applicant desires to install a Utility on Public Right-of-Way.
3. THAT, in consideration of this agreement, the County does hereby permit Applicant to lay, install and construct said Utility in the Public Right-of-Way between Co Rd 20 & Co Rd 21 along CO RD O, @ Intersection CO RD 5 & CO RD 12 going South 500' along CO RD 5 (Description of Property or Sections) in SE Corner Sect 09, T-18-N, R-08-E, SE Corner Sect 16, T-19-N, R-09-E Township, Dodge County, Nebraska.
4. THAT, the permit on the part of Dodge County is revocable at the will of the County, and Applicant agrees that upon written notice from the County Board of Supervisors, he will immediately and forthwith remove said Utility and any and all pipes or other material contained or used in connection with said Utility and return the roadway occupied by said Utility to substantially it's original condition as before installation of said Utility.
5. THAT, the Applicant shall notify the Highway Superintendent and local Township for the purpose of removing the gravel windrow to the opposite side of road so as not to lose any gravel in the open trench.
6. THAT, all backfill in the Public Right-of-Way proper shall be made with material excavated from the crossing or with material equivalent thereto in texture. Material shall be placed in six inch lifts for the full depth of the trench and compacted by tamping to the original cross section. All utilities placed in areas susceptible to erosion shall place adequate protection against erosion. This protection may include bale checks, silt fence and erosion blankets. All vegetation destroyed shall be replaced. Disturbed areas will be reseeded with native grasses and a starter fertilizer. The minimum depth of earth cover over the utility line shall be 3 feet. Installation of underground utility lines under the traveled portion of an existing county road way must be encased in a plastic or steel conduit. The casing shall be bored from the toe of the shoulder slope to the toe of the opposite shoulder slope. The utility shall be placed at a minimum depth of 3 feet below the bottom elevation of the parallel road ditch. Applicant and his contractor or subcontractors are responsible for temporary traffic control on Dodge County Right-of-Way based on the standards and guidelines found in Part 6 of the 2009 Edition of the Manual on Uniform Traffic Control Devices (MUTCD) to insure a safe work zone for the workers and the public. Applicant will provide all necessary signs, barricades, cones, flaggers and message boards.
7. THAT, the Applicant shall obtain approval of all County road restoration from the County Highway Superintendent or Township Official prior to leaving the site(s).
8. THAT, all backfilled area(s) disturbed by excavation and backfill operations shall be graded, hand dressed as required to restore the terrain to its original shape, grade, and cross section, and regraded or reroaked at a rate of 150 tons per mile as directed by the County Highway Superintendent or Township Official.
9. THAT, the Applicant shall as directed by the County Highway Superintendent or Township Official remove at the Applicant's expense from the Public Right-of-Way all temporary structures, and waste materials resulting from their operations.
10. THAT, the Applicant shall file a scaled set of plans, showing the Utility route, depth, and distance from the section line with the Dodge County Highway Superintendent.
11. THAT, the Applicant shall when installing an aerial Utility, shall install such Utility one foot inside the Public Right-of-Way and at a minimum height of 18 feet above the traveled way.
12. THAT, the future maintenance of said Utility and reinstallation or reconstruction of same for any purpose whatsoever shall be borne by Applicant.
13. THAT, Applicant does hereby agree to hold the County or any of its Officers, Agents, or Employees forever harmless of all liabilities due to improper installation, construction, and maintenance of said Utility.
14. ~~THAT, the Applicant shall submit an Insurance Certificate verifying General Liability of \$1,000,000.00; Personal Injury of \$500,000.00; Product & Completed Operations Aggregate of \$1,000,000.00; Medical Expense (Any One Person) of \$5,000.00; Each Occurrence of \$500,000.00. Certificate to be filed with this application.~~
15. THAT, this permit is valid for 6 months from the date of issuance or reapplication is required to renew.

IN WITNESS WHEREOF, the parties aforesaid have hereto set their hand this 13th day of January, 2022

DocuSigned by:  
Sharyl L. McGuire  
Signature of Applicant

[Signature]  
Dodge County Highway Superintendent

OMAHA PUBLIC POWER DISTRICT  
ATTN: Alyssa Bryant, GE/EP3  
444 S 16<sup>TH</sup> ST MALL  
OMAHA, NE 68102-2247  
Address of Applicant

April 6, 2022  
Date Filed with Dodge County Board of Supervisors

2022 MAR 22 AM 10:46  
RECEIVED  
Dodge County Highway Dept



- 0072884201
  - 1. ROL 2-1/2" DIA. / 2-1/2" DIA. 810 3000.
  - 2. ROL 2-1/2" DIA. / 2-1/2" DIA. 810 3000. 1-1/2" DIA. 1500 RLP 14 14
  - 3. ROL 2-1/2" DIA. / 2-1/2" DIA. 810 3000. 1-1/2" DIA. 1500 RLP 14 14
  - 4. ROL 2-1/2" DIA. / 2-1/2" DIA. 810 3000. 1-1/2" DIA. 1500 RLP 14 14
  - 5. ROL 2-1/2" DIA. / 2-1/2" DIA. 810 3000. 1-1/2" DIA. 1500 RLP 14 14
- CONDUCTOR NOTE
- 1. ROL 1-1/2" AL 3500 24 PIR DA. 6000 6-1/2" AL 3500 RLP 14 14
  - 2. ROL 1-1/2" AL 3500 24 PIR DA. 6000 6-1/2" AL 3500 RLP 14 14
  - 3. ROL 1-1/2" AL 3500 24 PIR DA. 6000 6-1/2" AL 3500 RLP 14 14
- CONDUCTOR NOTE
- 1. ROL 1-1/2" AL 3500 24 PIR DA. 6000 6-1/2" AL 3500 RLP 14 14
  - 2. ROL 1-1/2" AL 3500 24 PIR DA. 6000 6-1/2" AL 3500 RLP 14 14
  - 3. ROL 1-1/2" AL 3500 24 PIR DA. 6000 6-1/2" AL 3500 RLP 14 14
- CONDUCTOR NOTE
- 1. ROL 1-1/2" AL 3500 24 PIR DA. 6000 6-1/2" AL 3500 RLP 14 14
  - 2. ROL 1-1/2" AL 3500 24 PIR DA. 6000 6-1/2" AL 3500 RLP 14 14
  - 3. ROL 1-1/2" AL 3500 24 PIR DA. 6000 6-1/2" AL 3500 RLP 14 14

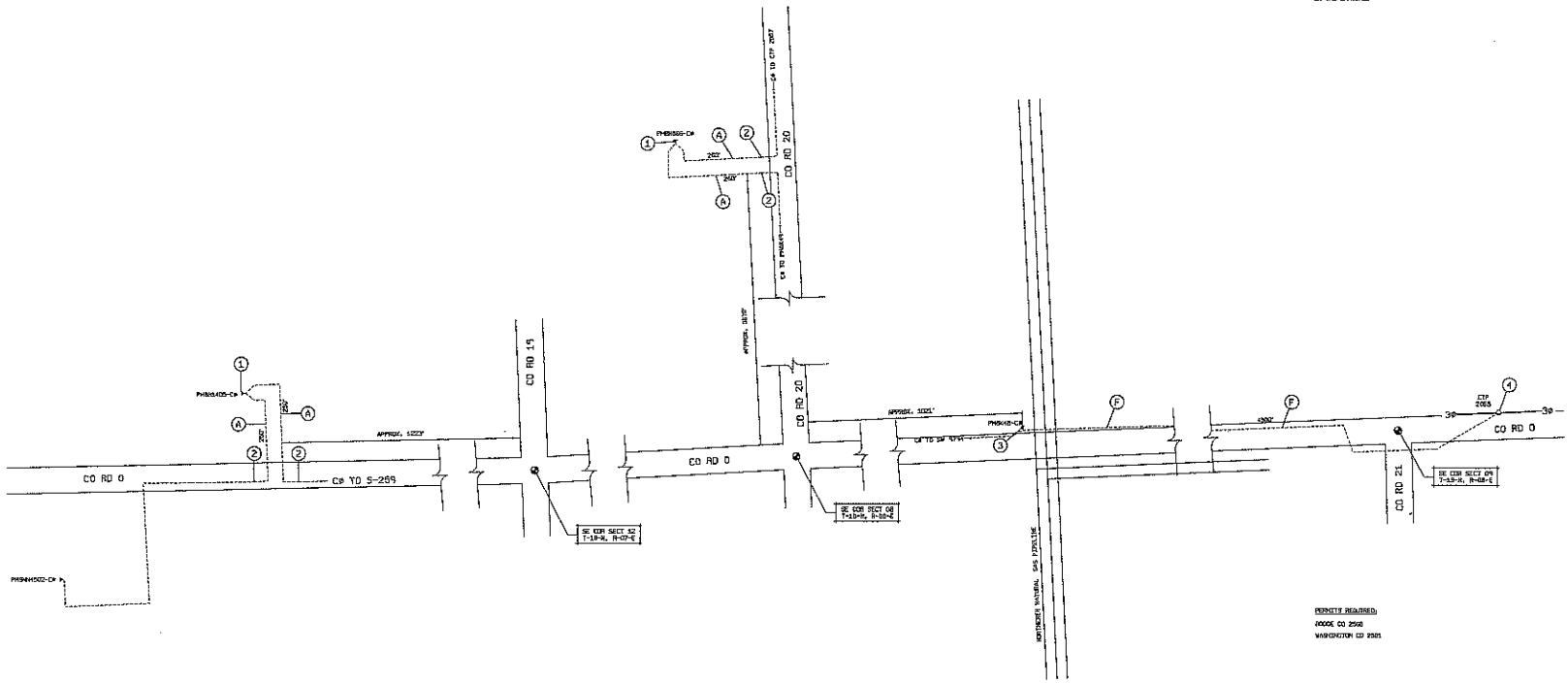

REVISED DRAWING  
10000 CD 2500  
WASHINGTON CD 2500

GRAPHIC SCALE  
0 100 200  
SCALE: 1" = 100'

REVISIONS		DESCRIPTION	
1	SCALE	1" = 100'	
2	DATE	01-14-20	AKJ
3	NO.		
4	NAME	AKJ	
5	DATE		
6	NO.		
7	DATE	01-14-20	AKJ
8	NO.		
9	DATE		
10	NO.		
11	DATE		
12	NO.		
13	DATE		
14	NO.		
15	DATE		

**CABLE REPLACEMENT**

VIC OF CD RD 0  
& CD RD 20  
NICKERSON, NE

EXT 224

SKE-22-215  
SHEET 1 OF 2

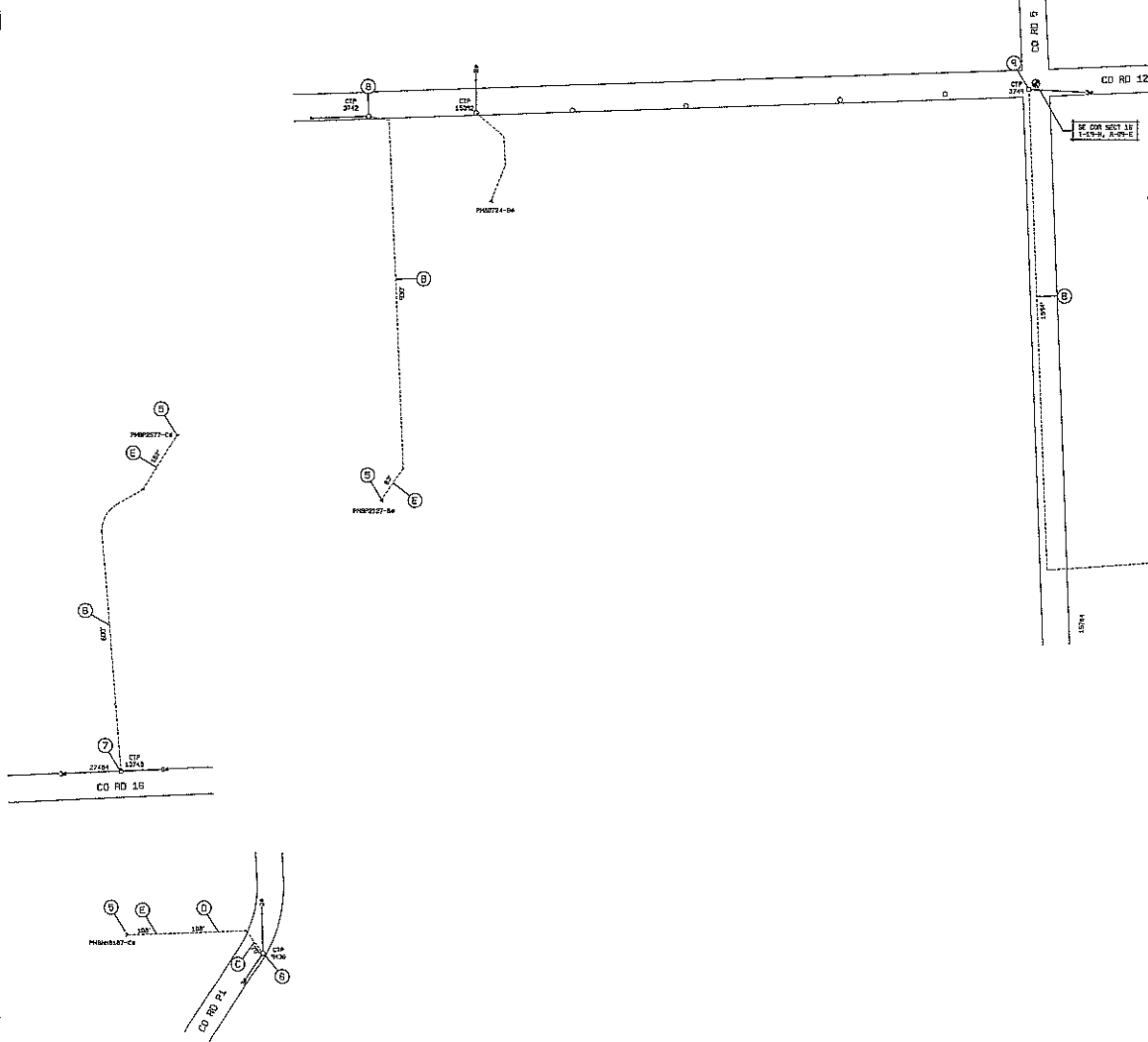

- 0072564204  
 5. PMP. STD 2775 / STD 2776.  
 B. CIP. W&E. PMP. STD 2775 (1200 CA. USE P&L CA.) / STD 2776 (1200 CA. USE P&L CA.). CHECK FOR STD 2775. 2776. STD. 2775. STD. 2776.  
 C. CIP. W&E. PMP. STD 2775 (1200 CA. USE P&L CA.) / STD 2776 (1200 CA. USE P&L CA.). CHECK FOR STD 2775. 2776. STD. 2775. STD. 2776.  
 D. CIP. W&E. PMP. STD 2775 (1200 CA. USE P&L CA.) / STD 2776 (1200 CA. USE P&L CA.). CHECK FOR STD 2775. 2776. STD. 2775. STD. 2776.  
 E. CIP. W&E. PMP. STD 2775 (1200 CA. USE P&L CA.) / STD 2776 (1200 CA. USE P&L CA.). CHECK FOR STD 2775. 2776. STD. 2775. STD. 2776.  
 F. CIP. W&E. PMP. STD 2775 (1200 CA. USE P&L CA.) / STD 2776 (1200 CA. USE P&L CA.). CHECK FOR STD 2775. 2776. STD. 2775. STD. 2776.
- CONDUCTOR NOTES  
 B. AMP. 1-1/2 AL. 1200 RLP. 18 PR. CA. PLY. 1-1/2 AL. 1200 RLP. 18 PR. CA. 1200 RLP. 18 PR. CA. 1200 RLP. 18 PR. CA.  
 C. AMP. 1-1/2 AL. 1200 RLP. 18 PR. CA. BORE 1-1/2 AL. 1200 RLP. 18 PR. CA. 1200 RLP. 18 PR. CA. 1200 RLP. 18 PR. CA.  
 D. AMP. 1-1/2 AL. 1200 RLP. 18 PR. CA. BORE 1-1/2 AL. 1200 RLP. 18 PR. CA. 1200 RLP. 18 PR. CA. 1200 RLP. 18 PR. CA.  
 E. AMP. 1-1/2 AL. 1200 RLP. 18 PR. CA. BORE 1-1/2 AL. 1200 RLP. 18 PR. CA. 1200 RLP. 18 PR. CA. 1200 RLP. 18 PR. CA.  
 F. AMP. 1-1/2 AL. 1200 RLP. 18 PR. CA. BORE 1-1/2 AL. 1200 RLP. 18 PR. CA. 1200 RLP. 18 PR. CA. 1200 RLP. 18 PR. CA.

GENERAL NOTE: INSTL. STD 2775 AT ALL SPLICE LOCATIONS NOT SHOWN ON THE DRAWING.

PERMITS REQUIRED:  
 GORGE CD 2640  
 WASHINGTON CD 2661

GRAPHIC SCALE:  
 1" = 200'  
 SCALE: 1" = 200'

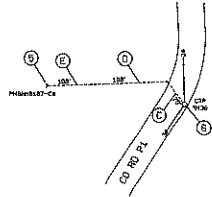

NO. 0072564204-10	DESCRIPTION:
1	SCALE: 1" = 200'
2	DRAFT: 11-11-00, AUC
3	CHECK:
4	DESIGN: ASSIGNED
5	DRAWN:
6	DATE:
7	APPROV. CD-21-22, M.P.
8	NOV. 2000
9	SUPPLY DISTRIBUTION
10	DIST. 224
<b>CABLE REPLACEMENT</b>	
VIC OF CD RD 0 & CD RD 20 NICKERSON, NE	
SKE-22-215	

**COPY**

**DODGE COUNTY UTILITY INSTALLATION AGREEMENT  
Public Utilities**

WITNESS, that this shall be an agreement between Dodge County, hereafter referred to as the County and OMAHA PUBLIC POWER DISTRICT, hereafter referred to as the Applicant. Whereas, the County and Applicant do hereby agree,

1. THAT, the Applicant shall be permitted to install a underground primary cable, through, or aerial, the Public Right-of-Way of Dodge County.
2. THAT, the County and Townships are the owners and responsible for the Public Right-of-Way in the County and Applicant desires to install a Utility on Public Right-of-Way.
3. THAT, in consideration of this agreement, the County does hereby permit Applicant to lay, install and construct said Utility in the Public Right-of-Way between VIC OF CO RD O & ST HWY 91 (Description of Property or Sections) in NE Corner Sect 14, T-18-N, R-09-E, Dodge County, Nebraska.
4. THAT, the permit on the part of Dodge County is revocable at the will of the County, and Applicant agrees that upon written notice from the County Board of Supervisors, he will immediately and forthwith remove said Utility and any and all pipes or other material contained or used in connection with said Utility and return the roadway occupied by said Utility to substantially it's original condition as before installation of said Utility.
5. THAT, the Applicant shall notify the Highway Superintendent and local Township for the purpose of removing the gravel windrow to the opposite side of road so as not to lose any gravel in the open trench.
6. THAT, all backfill in the Public Right-of-Way proper shall be made with material excavated from the crossing or with material equivalent thereto in texture. Material shall be placed in six inch lifts for the full depth of the trench and compacted by tamping to the original cross section. All utilities placed in areas susceptible to erosion shall place adequate protection against erosion. This protection may include bale checks, silt fence and erosion blankets. All vegetation destroyed shall be replaced. Disturbed areas will be reseeded with native grasses and a starter fertilizer. The minimum depth of earth cover over the utility line shall be 3 feet. Installation of underground utility lines under the traveled portion of an existing county road way must be encased in a plastic or steel conduit. The casing shall be bored from the toe of the shoulder slope to the toe of the opposite shoulder slope. The utility shall be placed at a minimum depth of 3 feet below the bottom elevation of the parallel road ditch. Applicant and his contractor or subcontractors are responsible for temporary traffic control on Dodge County Right-of-Way based on the standards and guidelines found in Part 6 of the 2009 Edition of the Manual on Uniform Traffic Control Devices (MUTCD) to insure a safe work zone for the workers and the public. Applicant will provide all necessary signs, barricades, cones, flaggers and message boards.
7. THAT, the Applicant shall obtain approval of all County road restoration from the County Highway Superintendent or Township Official prior to leaving the site(s).
8. THAT, all backfilled area(s) disturbed by excavation and backfill operations shall be graded, hand dressed as required to restore the terrain to its original shape, grade, and cross section, and regradeed or reroocked at a rate of 150 tons per mile as directed by the County Highway Superintendent or Township Official.
9. THAT, the Applicant shall as directed by the County Highway Superintendent or Township Official remove at the Applicant's expense from the Public Right-of-Way all temporary structures, and waste materials resulting from their operations.
10. THAT, the Applicant shall file a scaled set of plans, showing the Utility route, depth, and distance from the section line with the Dodge County Highway Superintendent.
11. THAT, the Applicant shall when installing an aerial Utility, shall install such Utility one foot inside the Public Right-of-Way and at a minimum height of 18 feet above the traveled way.
12. THAT, the future maintenance of said Utility and reinstallation or reconstruction of same for any purpose whatsoever shall be borne by Applicant.
13. THAT, Applicant does hereby agree to hold the County or any of its Officers, Agents, or Employees forever harmless of all liabilities due to improper installation, construction, and maintenance of said Utility.
14. THAT, the Applicant shall submit an Insurance Certificate verifying General Liability of \$1,000,000.00; Personal Injury of \$500,000.00; Product & Completed Operations Aggregate of \$1,000,000.00; Medical Expense (Any One Person) of \$5,000.00; Each Occurrence of \$500,000.00. Certificate to be filed with this application.
15. THAT, this permit is valid for 6 months from the date of Issuance or reapplication is required to renew.

IN WITNESS WHEREOF, the parties aforesaid have hereto set their hand this 23 day of MARCH, 2022

DocuSigned by:  
Sharyl L McGuire  
Signature of Applicant

[Signature]  
Dodge County Highway Superintendent

OMAHA PUBLIC POWER DISTRICT  
ATTN: ALYSSA BRYANT, BE/EP3  
444 S 16<sup>TH</sup> ST MALL  
OMAHA, NE 68102-2247  
Address of Applicant

April 6, 2022  
Date Filed with Dodge County Board of Supervisors

2022 MAR 24 AM 6:54  
RECEIVED  
DODGE COUNTY HIGHWAY DEPT

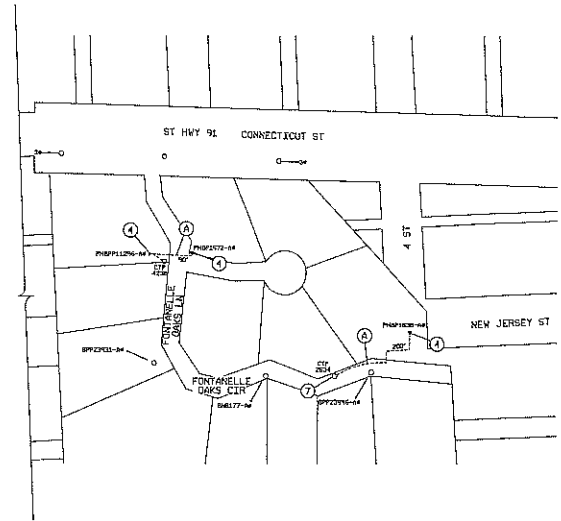
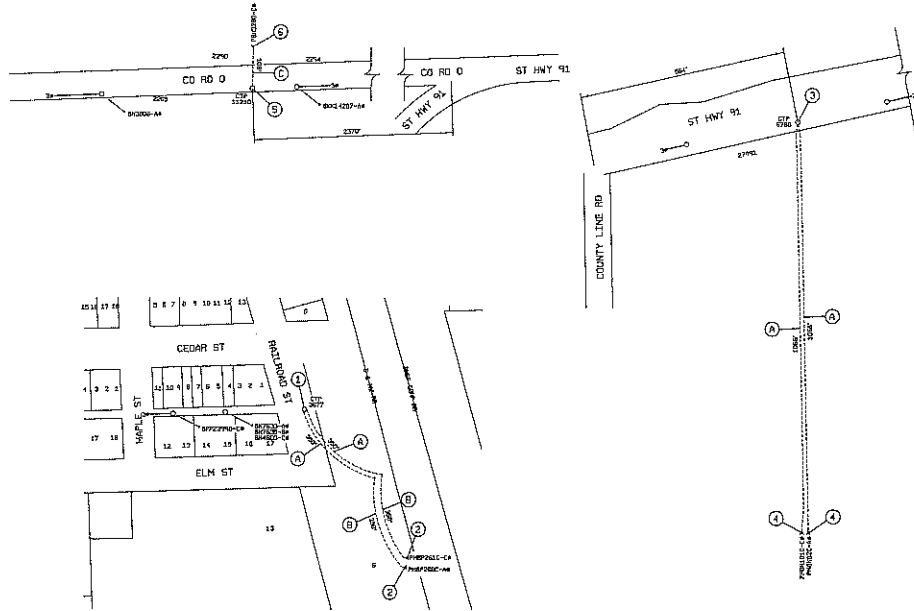

- REMARKS:**
1. 2"Ø 30FT. REEL, STD 1054 1200# CO. USE FUL. AM A. CA. LESS 84" / STD 1054 1200# CO. USE FUL. AM 1200# CO. USE FUL. CA. LESS 84". CHECK FOR ONE ROD, INSTL. STD. 400# 1" W/SHIM.
  2. REEL, STD 2970 / STD 2970.
  3. STD 2970. REEL, STD 1054 1200# CO. 1-1/2"Ø FUL. AM A. CA. / STD 1054 1200# CO. USE FUL. AM 1200# CO. USE FUL. CA. LESS 84". CHECK FOR ONE ROD, INSTL. STD. 400# 1" W/SHIM.
  4. REEL, STD 2970 / STD 2970.
  5. STD 1250. REEL, STD 1054 1200# CO. USE FUL. CA. / STD 1054 1200# CO. USE FUL. CA. CHECK FOR ONE ROD, INSTL. STD. 400# 1" W/SHIM.
  6. REEL, STD 2970 / STD 2970.
  7. STD 2970. REEL, STD 1054 1200# CO. USE FUL. AM / STD 1054 1200# CO. USE FUL. AM. CHECK FOR ONE ROD, INSTL. STD. 400# 1" W/SHIM.
- CONDUCTOR NOTES:**
- A. AREA 3'-1/2" AL. 350# XLP 14 FUL. CA. ROSE 1-1/2" AL. 150# XLP JCT 14 FUL. CA 1000000041.
  - B. AREA 3'-1/2" AL. 350# XLP 14 FUL. CA. ROSE 1-1/2" AL. 150# XLP JCT 14 FUL. CA 1000000041.
  - C. AREA 3'-1/2" AL. 350# XLP 14 FUL. CA. ROSE 1-1/2" AL. 150# XLP JCT 14 FUL. CA 1000000041.

REVISIONS REQUIRED  
DATE 02 28/01

GRAPHIC SCALE  
1" = 100'  
SCALE 1" = 100'

NO. 0037000-01	DATE	DESCRIPTION
1	SCALE	1" = 100'
2	DATE	12-20-20
3	BY	AKC
4	PROJECT	REPL PRI CA
5	APPD.	05-23-21, 10.7
6	DATE	05-23-21
7	BY	AKC
8	DATE	05-23-21
9	BY	AKC
10	DATE	05-23-21
11	BY	AKC
12	DATE	05-23-21
13	BY	AKC
14	DATE	05-23-21
15	BY	AKC
16	DATE	05-23-21
17	BY	AKC
18	DATE	05-23-21
19	BY	AKC
20	DATE	05-23-21
21	BY	AKC
22	DATE	05-23-21
23	BY	AKC
24	DATE	05-23-21
25	BY	AKC
26	DATE	05-23-21
27	BY	AKC
28	DATE	05-23-21
29	BY	AKC
30	DATE	05-23-21
31	BY	AKC
32	DATE	05-23-21
33	BY	AKC
34	DATE	05-23-21
35	BY	AKC
36	DATE	05-23-21
37	BY	AKC
38	DATE	05-23-21
39	BY	AKC
40	DATE	05-23-21
41	BY	AKC
42	DATE	05-23-21
43	BY	AKC
44	DATE	05-23-21
45	BY	AKC
46	DATE	05-23-21
47	BY	AKC
48	DATE	05-23-21
49	BY	AKC
50	DATE	05-23-21

**REPL PRI CA**

VIC OF ST HWY 91  
8 CD RD 24  
NICKERSON, NE

DKT 224  
SKE-21-1668