

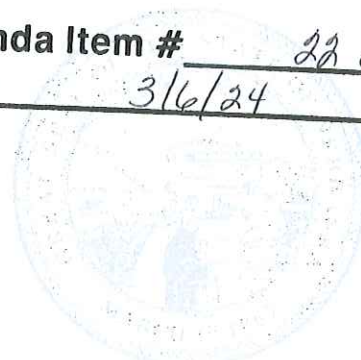

**COPY**



February 22, 2024

Jim Pillen, Governor

Micki Gilfry, County Clerk  
Dodge County  
435 N Park  
Fremont, NE 68025

Re: Federal-Aid Urban Area Boundary Update

Dear Ms. Gilfry:

The Nebraska Department of Transportation (NDOT) is once again in the process of reviewing the Adjusted Urban Area Boundaries and National Functional Classification (NFC) System following the release of the 2020 United States Census information.

After the release of the decennial census, the United States Census Bureau has updated existing census data as it relates to Federal-Aid Urban Area Boundaries. This means existing urban area boundaries must be adjusted accordingly. The 2020 United States Code for Federal Transportation legislation declares both "Urban Areas" and "Urbanized Areas":

"(23 U.S.C. Sec 101 (a) (33) & (34) ... Designated by the Bureau of the Census within boundaries to be fixed by responsible State and local officials in cooperation with each other, subject to approval by the Secretary. Such boundaries shall encompass, at minimum, the entire urban place designated by the Bureau of the Census."

We are asking for your assistance in this task of updating the Adjusted Urban Area Boundary in agreement with the current 2020 Census data. Please coordinate your review with City Officials.

I have enclosed a copy of the latest Dodge County Urban Area Map for review by the Dodge County Board. If the board concurs that the Adjusted Urban Area Boundary is correct, please have a designated representative sign the signature block and return the map in the enclosed envelope.

However, if there are any changes, please do the following:

1. Describe what the change is and where it is located.
2. If applicable, submit supporting documentation that supports the County/City perspective.
3. Sign the signature block and return the map in the enclosed envelope.

Once NDOT concurs with any revisions to the Adjusted Urban Area Boundary, the revisions will be forwarded to FHWA for their review and approval. Following the approval of the Urban Area Boundary we will begin the NFC System review.

In order to accomplish the review in a timely manner, please return the signed map by May 22, 2024.

If you need any further assistance, please contact me at (402) 479-3889 or [dana.hartung@nebraska.gov](mailto:dana.hartung@nebraska.gov).

Sincerely,

  
Dana Hartung, Highway Materials & Test Manager

Vicki Kramer, Director

Enclosure Department of Transportation

Materials & Research Division  
1400 Nebraska Parkway  
PO Box 94759  
Lincoln, NE 68509-4759

OFFICE 402-479-4750 FAX 402-479-3975  
DOT.ContactUs@nebraska.gov

[dot.nebraska.gov](http://dot.nebraska.gov)

2024 FEB 28 PM 12:11  
RECEIVED  
Dodge County Highway Dept

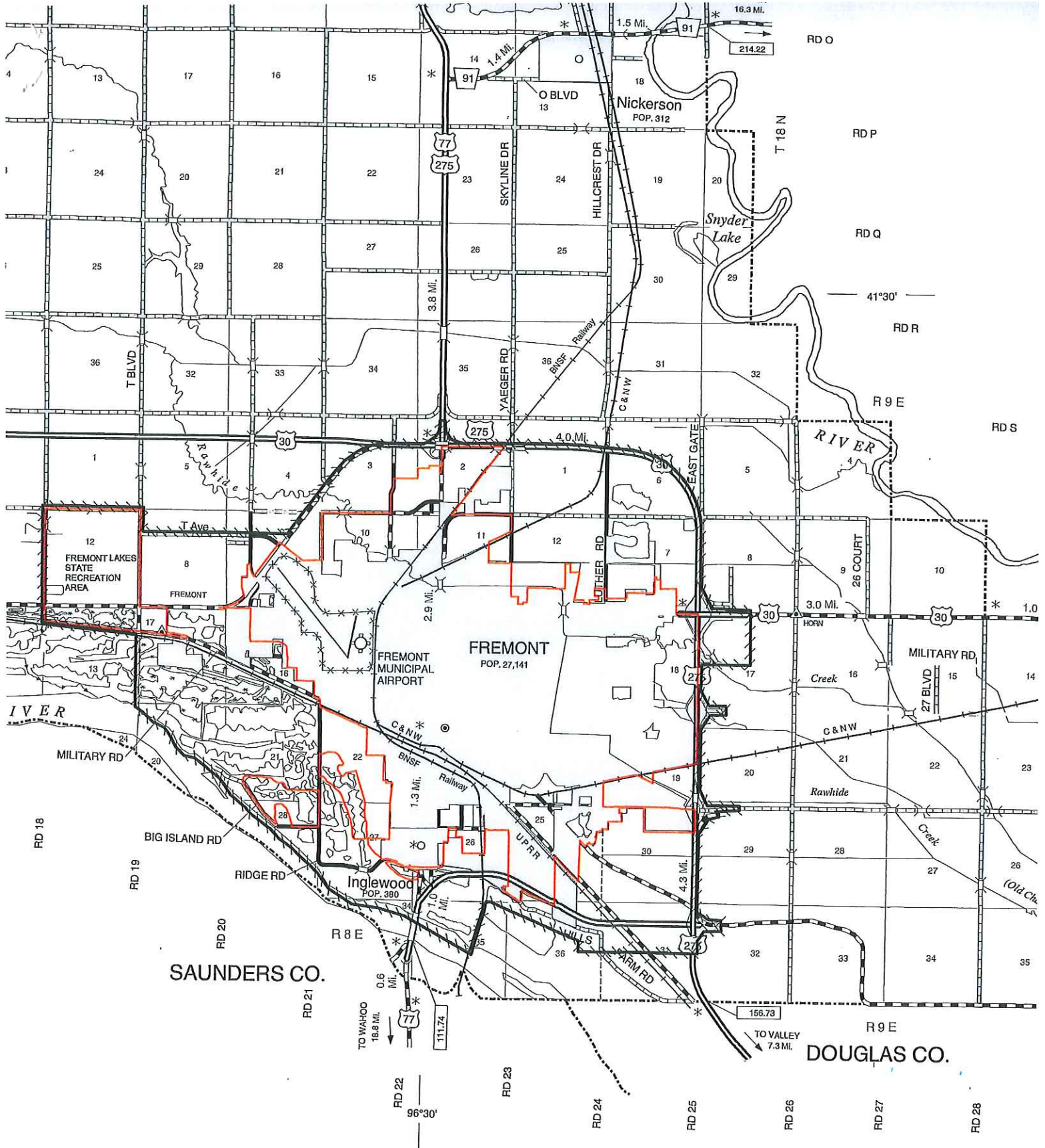

SAUNDERS CO.

DOUGLAS CO.

TO WAHOO  
18.8 MI.

TO VALLEY  
7.3 MI.

96°30'

41°30'

RD O

RD P

RD Q

RD R

RD S

RD 18

RD 19

RD 20

RD 21

RD 22

RD 23

RD 24

RD 25

RD 26

RD 27

RD 28

T 18 N

R 9 E

R 9 E

SKYLINE DR

HILLCREST DR

YAEGER RD

RAILWAY

C & N W

EAST GATE

LUTHER RD

26 COURT

MILITARY RD

BIG ISLAND RD

RIDGE RD

INGLEWOOD

UPPR

HILLS

ARM RD

(Old Ch)

RIVER

RIVER

Snyder Lake

Rawhide

Creek

Rawhide

Creek

(Old Ch)

1.4 MI.

1.5 MI.

16.3 MI.

275

91

91

214.22

275

FREMONT  
POP. 27,141

INGLEWOOD  
POP. 380

Nickerson  
POP. 312

FREMONT LAKES  
STATE RECREATION  
AREA

FREMONT  
MUNICIPAL  
AIRPORT

3.0 MI.

HORN

30

1.0

30

0.6 MI.

7

111.74

156.73

18.8 MI.

7

111.74

156.73

7.3 MI.

7

156.73

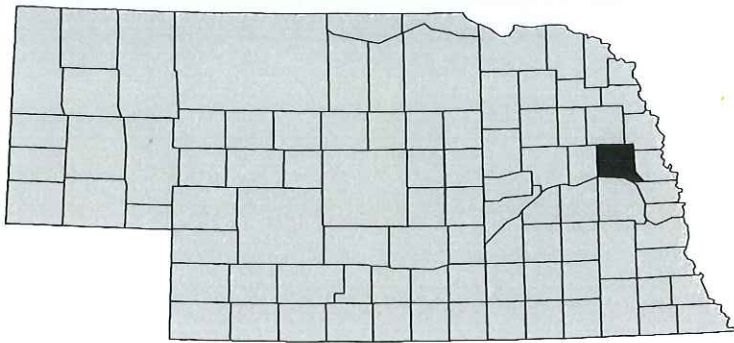

**LEGEND**

**CENSUS BOUNDARY** \_\_\_\_\_

**ADJUSTED URBAN AREA BOUNDARIES** \_\_\_\_\_

**URBAN AREA BOUNDARY  
SIGNATURE BLOCK**

SIGNATURE OF RESPONSIBLE OFFICIAL \_\_\_\_\_

OFFICIAL TITLE \_\_\_\_\_

GOVERNMENT ENTITY (Please enter the name of the County or City)

\_\_\_\_\_ COUNTY BOARD

\_\_\_\_\_ CITY COUNCIL

APPROVED REVIEW DATE: \_\_\_\_\_

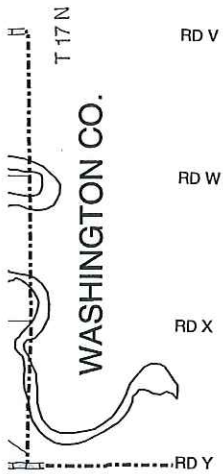

**NEBRASKA**

Good Life. Great Journey.

**DEPARTMENT OF TRANSPORTATION**