

# GENERAL HIGHWAY MAP DODGE COUNTY NEBRASKA

PREPARED BY THE  
DEPARTMENT OF ROADS  
GIS/MAPPING SECTION  
IN COOPERATION WITH THE  
U.S. DEPARTMENT OF TRANSPORTATION  
FEDERAL HIGHWAY ADMINISTRATION  
2011

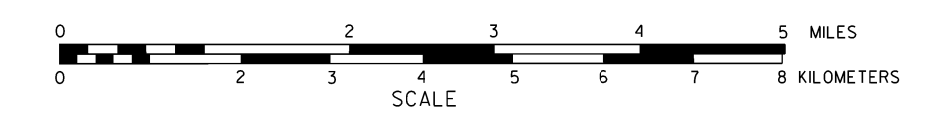

DATE	REVISION
FEBRUARY, 2011	SUPERINTENDENT MAP
NOVEMBER, 2011	COUNTY
NOVEMBER, 2011	COUNTY LINE CHANGE - USFT

### LEGEND

- |  |       |   |       |
|--|-------|---|-------|
| Primitive Road                                 | ..... | Filling Station                             | ..... |
| Unimproved Road                                | ..... | Grain Elevator                              | ..... |
| Gravel or Crushed Rock                         | ..... | Aggregate Pit                               | ..... |
| Asphalt/Bituminous Surface                     | ..... | Agricultural Experimental Station           | ..... |
| Multilane Lane Unimproved Highway              | ..... | Educational Institutions                    | ..... |
| Asphalt/Bituminous Surface                     | ..... | Public Use Area                             | ..... |
| Concrete/Block Surface                         | ..... | State Parks, Game Lands, Wildlife, etc.     | ..... |
| Multilane Lane Unimproved Highway              | ..... | Statewide Facilities                        | ..... |
| Concrete/Block Surface                         | ..... | Rest Area                                   | ..... |
| Divided Highway                                | ..... | Ranger Station                              | ..... |
| Interstate Highway with Full Control of Access | ..... | Fish Hatchery                               | ..... |
| Side Roads and Streets                         | ..... | Community Hall                              | ..... |
| 911 NAMES/Numbered Roads                       | ..... | Correctional Institution                    | ..... |
| ADAMS ROAD                                     | ..... | Tourist Court or Motel                      | ..... |
| Interstate-Numbered Highway                    | ..... | Monument-Small                              | ..... |
| Community Highway                              | ..... | Museum                                      | ..... |
| US-Numbered Highway                            | ..... | Fire Station                                | ..... |
| State-Numbered Highway                         | ..... | Courthouse                                  | ..... |
| State-Numbered Highway Spur                    | ..... | Post Office                                 | ..... |
| State-Numbered Highway Link                    | ..... | Highway Maintenance Yard                    | ..... |
| Highway Reference Post Number                  | ..... | Dump Area                                   | ..... |
| Interstate Exit Number                         | ..... | Sewage Disposal Plant                       | ..... |
| Wide Stream                                    | ..... | Water Supply Stand Pipe                     | ..... |
| Narrow Stream                                  | ..... | Road or TV Station                          | ..... |
| Irrigation Ditch                               | ..... | Weight Station or Port of Entry             | ..... |
| Reservoir, Pond or Lake                        | ..... | Commercial or Municipal Airport             | ..... |
| Reservoir with Dam                             | ..... | Airport with Paved Runways                  | ..... |
| Highway Bridge Any Type                        | ..... | State Boundary                              | ..... |
| Small Bridges-Closely Spaced                   | ..... | Township Line                               | ..... |
| Large Bridges-Indicate Name                    | ..... | Section Line                                | ..... |
| General Bridge                                 | ..... | Corporate Lines Lines                       | ..... |
| Arch Bridge                                    | ..... | Parks and Other Reservations                | ..... |
| Truss Bridge                                   | ..... | Boundary Limits of Area Shown in Error      | ..... |
| Pedestrian Underpass                           | ..... | State Capital                               | ..... |
| Railroad Overpass                              | ..... | County Seat                                 | ..... |
| Railroad Underpass                             | ..... | Other Cities and Villages                   | ..... |
| Railroad                                       | ..... | Incorporated City or Village                | ..... |
| Canal with Road on Top                         | ..... | Triangulation Station                       | ..... |
| Canal Super                                    | ..... | Points Between which Distances are Measured | ..... |
| Canal  | ..... | Hospital                                    | ..... |
| Church or Other Religious Institution          | ..... | Latitude and Longitude                      | ..... |
| Church with Cemetery Adjacent                  | ..... |   |       |
| Business                                       | ..... |   |       |
| Industrial Plant                               | ..... |   |       |

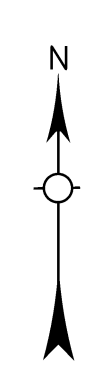

LAMBERT CONFORMAL CONIC PROJECTION  
83 NORTH AMERICAN DATUM  
NEBRASKA COORDINATE SYSTEM

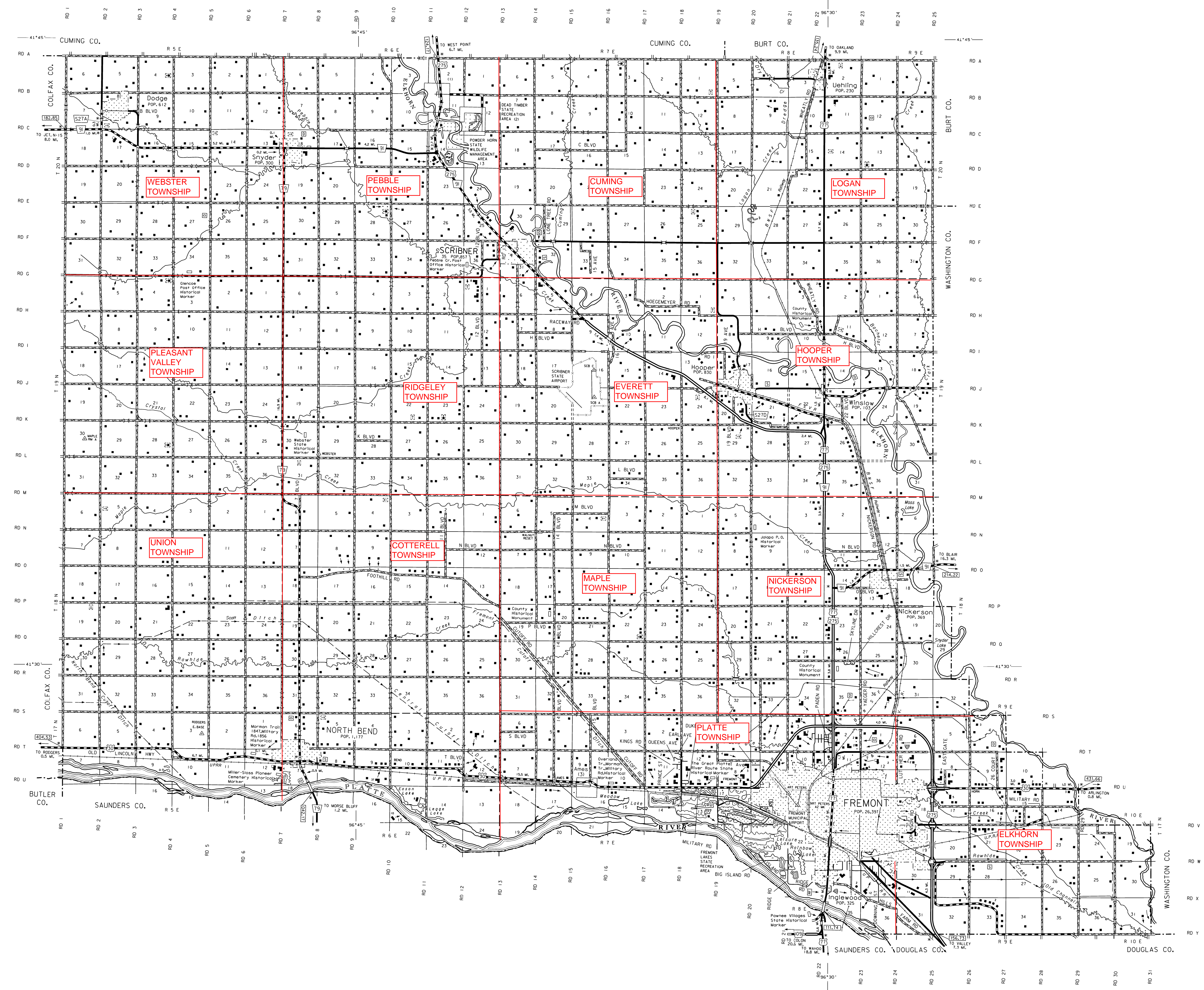
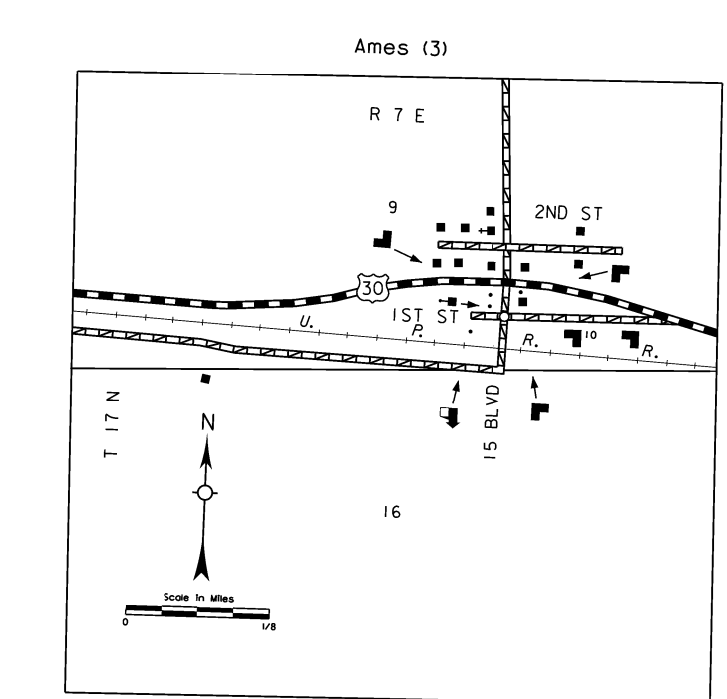
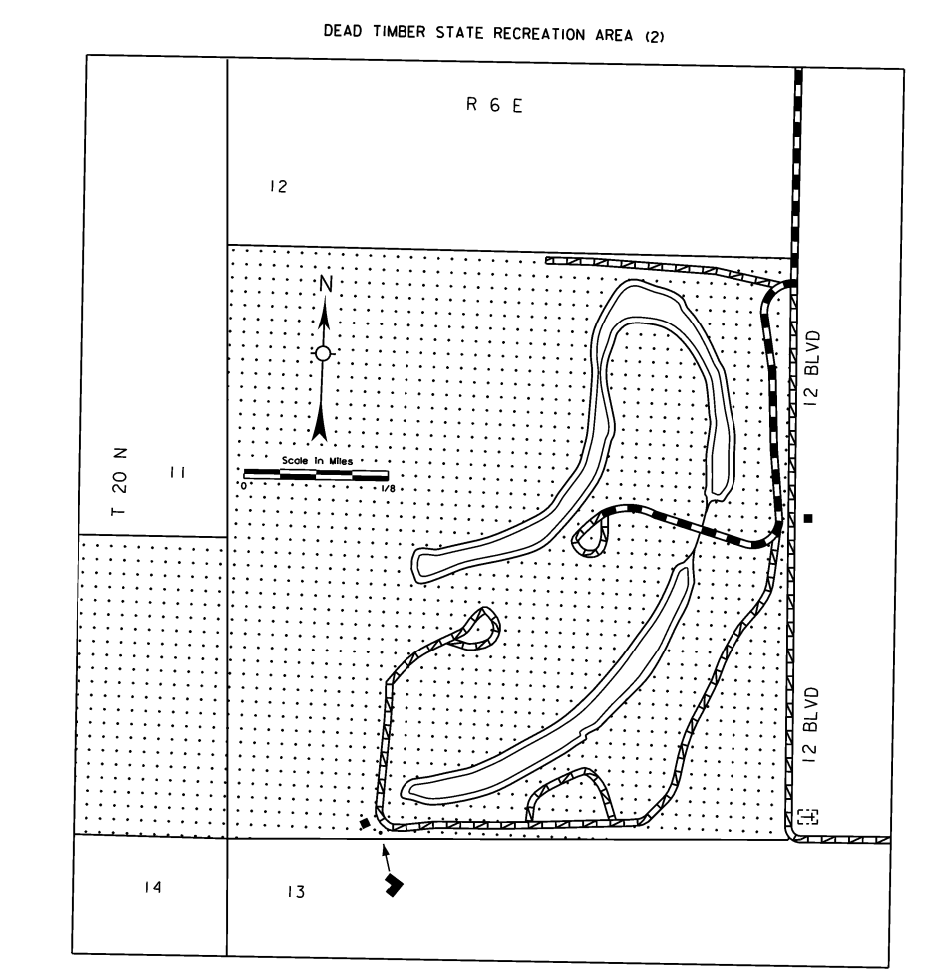
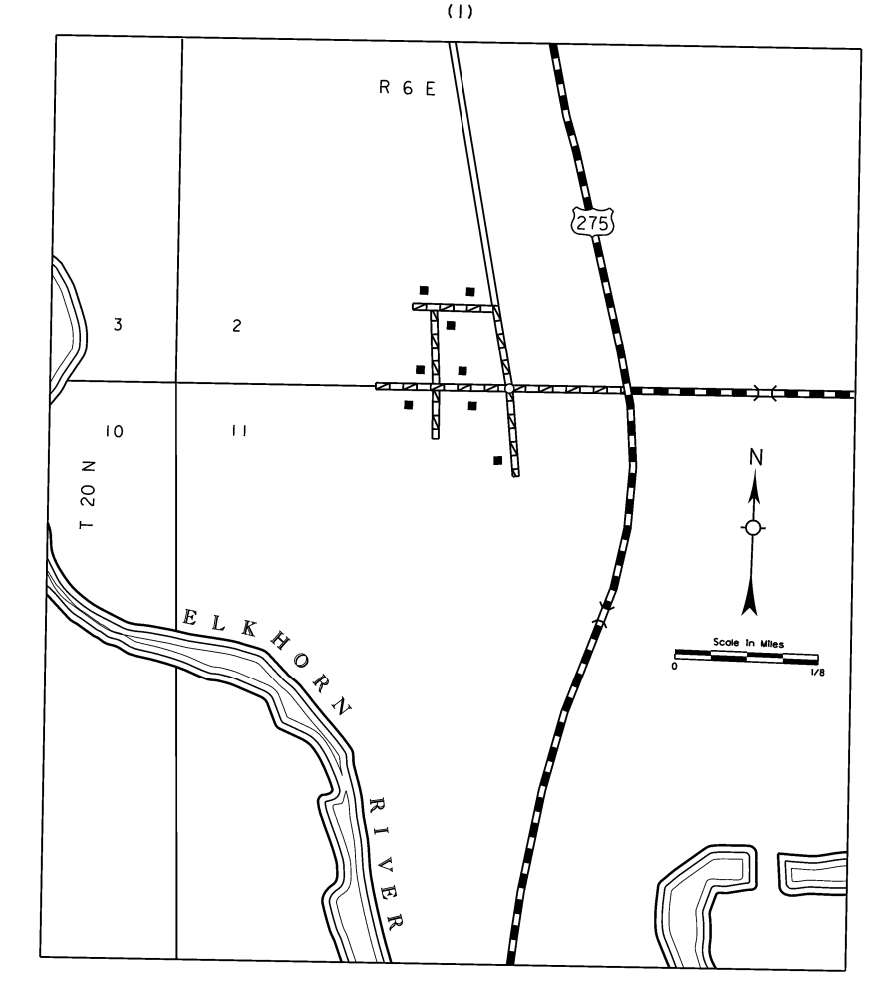
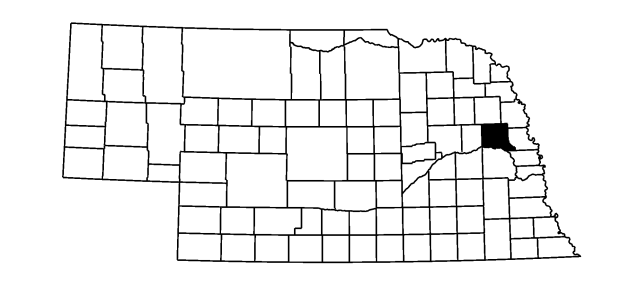

POPULATION AS OF 2011 CENSUS  
STATE HIGHWAYS CORRECTED TO 2011  
DIGITAL AERIAL PHOTOGRAPHY (DOADO)

This map is to be used for information only and is not intended to show ownership or to be definitive on any road or public utility. Under Nebraska Law, the Nebraska Department of Roads makes no warranty, guarantee, or representation for the accuracy of this information and disclaims its liability for errors or omissions. Any inconsistencies should be reported to NDOR.