

2022



Dodge County Directory, Tax & Voter Information Booklet

OFFICE LOCATIONS

COURTHOUSE, 435 N. Park:

Basement.....	Building Superintendent Emergency Management
First Floor.....	Treasurer Department of Motor Vehicles Drivers' Examiners County Clerk Election Commissioner General Assistance Program
Second Floor.....	Register of Deeds County Surveyor County Assessor Noxious Weed Control Authority Highway Superintendent Building Inspector/Zoning Dept. Veterans Service
Third Floor.....	Board of Supervisors Meeting Room County Attorney & Restitution State Child Support Enforcement Office Walkway to Judicial Center
Fourth Floor	Mediation Office CASA

JUDICIAL CENTER, 428 N. Broad:

First Floor.....	Sheriff
Second Floor.....	Booking & Holding Facility
Third Floor.....	County Judge, District Judge and Clerk of District Court

OTHER OFFICES:

Extension Service	1206 West 23rd
Probation	2860 West 23rd Street

Good Day, Citizen of Dodge County!

This booklet is designed to help you understand county government. It's divided into three areas.

The first section, the directory of officials and the "Where to go for " provides a means to get your questions and problems answered by the appropriate person. It answers all the questions of who, what, where and when.

The second section deals with elections. Included are places to register and polling places.

Finally, the third section deals with the most complex problem of county government, budgets and taxation. An effort has been made to help you figure your property taxes, find out where it is distributed, and other sources of money for the county besides direct taxation.

Trying to help,

FRED MYTTY

County Clerk

<https://www.dodgecounty.nebraska.gov/>
Official website

COUNTY OFFICIALS DIRECTORY Quick Reference DODGE COUNTY BOARD OF SUPERVISORS



Name	(left to right in picture) District	Phone
Bob Bendig 1309 Stanford Ave. Fremont NE 68025	1	402-727-4959
Greg Beam 1150 N. Ridge Road Dr. Fremont, NE 68025	2	402-720-7944
Lon Strand, Vice-Chairman 2239 Co. Rd. E Hooper, NE 68031	3	402-654-2455
Pat Tawney 615 Shoreline Dr. #51 North Bend NE 68649	4	402-719-1225
Bob Missel, Chairman 427 N. Birchwood Fremont, NE 68025	5	402-317-7832
Dan M. Weddle 2534 Missouri Ave. Fremont, NE 68025	6	402-721-2651
Doug Backens 1820 N. Nye Ave. Fremont, NE 68025	7	402-306-3420

Clerk 402-727-2767
Deputy
Fred Mytty
Micki Gilfry

Treasurer 402-727-2750
Deputy
Gail J. Bargstadt
Judith Main

Register of Deeds 402-727-2735
Deputy
Carol Givens
Michelle Weston

Assessor 402-727-3911
Debbie Churchill

Clerk of District Court 402-727-2780
Deputy
Linda Nelson
Judith Wegner

Sheriff 402-727-2702
Chief Deputy
Robert D. Reynolds

Director of Corrections 402-443-8142
Served by Saunders
County Sheriff Kevin
Stukenholtz

Attorney 402-727-2725
Chief Deputy
Sara Sopinski
Bri McLarty

County Judge 402-727-2755
Kenneth J. Vampola

District Judge 402-727-2780
Geoffrey Hall

Child Support Enforcement Attorney
877-631-9973
Michael Bailey

Surveyor 402-816-4305
Clark A. Boschult

Highway Superintendent 402-727-2722
Scott Huppert

Building Inspector 402-727-2724
Todd Nielsen

Zoning Bldg. Administrator 402-727-2724
Jean Andrews

Extension Educator 402-727-2775
Lisa Poppe

Diversion Program Director 402-727-2795
Christina Hagelstien

Supt. Courthouse & Grounds 402-727-2716
Dana Nielsen

Emergency Manager 402-727-2785
Thomas Smith

Noxious Weed Control Supt 402-727-2718
Larry Klahn

Veterans Service Officer 402-727-2719
Mark Schneck

Chief Probation Officer 402-727-2790
Patty Lyon

DODGE COUNTY VETERAN'S SERVICE BOARD

Brad Martindale
Alton K. Crook
Josh Kaup
Stan Vyhlidal
Leonard Kemp
Mark Schneck, Secretary

North Bend
Fremont
Scribner
Fremont
Dodge
Hooper

PLANNING COMMISSION

Matt Giesselmann
Tom Weitzenkamp
Allen Rolf, Secretary
Brad Fooker Vice-Chairman
Adam Taylor
Gene Ruzicka
Scott Wagner
Marvin Hansen
Marlin Brabec, Chairman

Scribner
Hooper
Dodge
Fremont
Ames
North Bend
Hooper
Ames
Ames

BOARD OF ADJUSTMENT

Becky Von Seggern, Secretary
Vernon Brandert
Marlin Brabec, alternate
Russell Rabeler, Chairman
Ken Molacek
Larry Ruzicka, Vice-Chairman

Scribner
Hooper
Ames
Fremont
Fremont
North Bend

VISITORS BUREAU ADVISORY COMMITTEE

Molly Paden
Vince O'Connor
Christopher Bristol
Lisa Schole
Becky Stecher
Stephen Dorsey
Kirk Brown

Fremont
Fremont
Fremont
Hooper
Dodge
Fremont
Fremont

**FREMONT COMMUNITY HEALTH RESOURCES
BOARD OF TRUSTEES**

Larry Shepard
Linda McClain
Steve Pribnow

Fremont
Fremont
Ames

DODGE COUNTY FAIR BOARD

Philip Stollberg, Scribner	Director
Mitch Miller, Nickerson	Vice-President
Becky Lynn, Uehling	Treasurer
Lisa Schole, Hooper	President
Houston Moseman, Fremont	Fair Manager
Al Settles, Scribner	Director
Beth Horvatich, Hooper	Director
Doug Vrana, North Bend	Director
Laurie Helgenberger, Scribner	Secretary
D.J. Mottl, North Bend	Director
Scott Langemeier, Scribner	Director
Justin Smith, Hooper	Director

Dodge County Fair Dates: August 3 - August 7, 2022
 Fremont 4-H Expo Dates: July 6 - 9, 2022

MEMBERS OF THE BOARD OF SUPERVISORS

- Bob Bendig**, 1309 Stanford Avenue, Fremont, NE
- District 1**, comprising Precincts 1 A, 1 C, 1 E, 4D within the City of Fremont, composed of 5,326 residents
- Greg Beam**, 1150 N. Ridge Road Dr., Fremont, NE
- District 2**, comprising Precincts 3A, 3B, 3C and 3D within the City of Fremont, composed of 5,350 residents.
- Lon Strand**, Vice-Chairman, 2239 County Road E, Hooper, NE
- District 3**, comprising the Cities of Hooper and Scribner, Townships of Hooper/Winslow, Logan, Everett, Cuming, Pebble, Nickerson and Webster, composed of 5,212 residents.
- Pat Tawney**, 615 Shoreline Dr. #51, North Bend, NE
- District 4**, comprising the City of North Bend, Townships of Elkhorn, Pleasant Valley, Ridgeley, Union, Cotterell, Maple and Platte East and West, composed of 5,125 residents.
- Bob Missel**, Chairman, 427 N. Birchwood, Fremont, NE
- District 5**, comprising Precincts 4A, 4B, 4C and 4E within the City of Fremont, composed of 5,424 residents.
- Dan M. Weddle**, 2534 Missouri Ave., Fremont, NE
- District 6**, comprising Precincts 1D, 2C, 2D, and 2E within the City of Fremont, composed of 5,255 residents.
- Doug Backens**, 1820 N. Nye Ave., Fremont, NE
- District 7**, comprising Precincts 1B, 2A, 2B, and 3E within the City of Fremont, composed of 5,472 residents.

Odd numbered supervisor districts are elected during gubernatorial elections. Even numbered supervisor districts are elected during presidential elections.

2022 Standing Board Committees

- FINANCE:** Bendig, Chairman; Missel, Beam (Entire board & Fred Mytty to participate in Budget Process)
- ROAD & BRIDGE:** Strand, Chairman; Tawney, Bendig
- COUNTY PROPERTY:** Strand, Chairman; Beam, Bendig
- PERSONNEL: JOB DESCRIPTION:** Beam, Chairman; Weddle, Backens
- COUNTY ZONING:** Tawney, Chairman, Weddle
- SECURITY COMMITTEE:** Weddle, Chairman; Tawney, Backens
- E.N.H.S.A.:** Tawney, Rep.; Weddle Alternate
- F.C.H.R.:** Missel, Rep.; Bendig Alternate
- JAIL STANDARDS:** Beam, Chairman; Tawney, Backens
- MUSEUM and HISTORICAL SOCIETY:** Beam, Rep; Missel, Alternate
- MERIT COMMISSION:** Backens
- LEGISLATIVE:** Missel, Rep; Backens, Alternate
- FREMONT AREA CHAMBER OF COMMERCE:** Weddle, Rep; Bendig, Alternate
- INSURANCE:** Jean Andrews (Beam, Board Rep)
- VISITOR'S PROMOTION BOARD:** Bendig, Rep; Weddle Alternate
- PSAP (Public Service Answering Point):** Missel, Chairman; Beam, Backens
- SAFETY:** Strand, Chairman; Micki Gilfry, Steve Hespen & Tim Walter
- SOLID WASTE:** Weddle, Rep; Strand, Alternate; Missel, Alternate
- THREE RIVERS PUBLIC HEALTH:** Backens, Rep; Bendig, Alternate
- NE NEBRASKA COMMUNITY ACTION:** Strand, Chairman, Tawney, Alternate
- COUNTY EXTENSION OFFICE:** Tawney, Liaison

NOTE: Lower Platte NRD; Lower Elkhorn NRD and Weed Board Committees will be handled by the **Road and Bridge Committee**.

NOTE: Members of the **PSAP committee** will represent the county on the governing board for the new Joint Public Service Center.

2022 TENTATIVE MEETING DAYS FOR DODGE COUNTY BOARD OF SUPERVISORS

JANUARY

12, Wednesday, at 9:00 A.M.
(Reorganization)
26, Wednesday, at 9:00 A.M.

FEBRUARY

9, Wednesday, at 9:00 A.M.
23, Wednesday, at 9:00 A.M.

MARCH

9, Wednesday, at 9:00 A.M.
23, Wednesday, at 9:00 A.M.

APRIL

6 Wednesday, at 9:00 A.M.
20, Wednesday, at 9:00 A.M.

MAY

4, Wednesday, at 9:00A.M.
18, Wednesday, at 9:00 A.M.

JUNE

1, Wednesday, at 9:00A.M.
15, Wednesday, at 9:00 A.M.
29, Wednesday, at 9:00 A.M.

JULY

13, Wednesday, at 9:00 A.M.
27, Wednesday, at 9:00 A.M.

AUGUST

10, Wednesday, at 9:00 A.M.
24, Wednesday, at 9:00 A.M.

SEPTEMBER

7, Wednesday, at 9:00 A.M.
21, Wednesday, at 9:00 A.M.

OCTOBER

5, Wednesday, at 9:00 A.M.
19, Wednesday, at 9:00 A.M.

NOVEMBER

2, Wednesday, at 9:00A.M.
16, Wednesday, at 9:00 A.M.
30, Wednesday at 9:00 A.M.

DECEMBER

14, Wednesday, at 9:00 A.M.
29, Wednesday, at 9:00 A.M.

All Board of Equalization meetings tentatively set beginning at 10:00 A.M. & Board of Corrections at 9:05 A.M.

2022 County Board Workshop is tentatively set for June 8th – June 10th (Wednesday – Friday)

2022 NACO Annual Conference tentatively set for December 14th – 16th (Wed. – Friday)

COURTHOUSE HOURS

Courthouse Hours – 8:30 A.M. – 4:30 P.M., unless otherwise stated by public notice.

Driver's Examiner's Hours – Wednesdays, Thursdays, and Fridays, 8:45 A.M. – 4:00 P.M. Driver's Manuals are available at the Sheriff's, Treasurer's, and Examiner's offices or online at <http://www.dmv.nebraska.gov/forms>.

2022 APPROVED COURTHOUSE HOLIDAYS

DAY OBSERVED	DAY OF THE WEEK	HOLIDAY
As approved by Official or Department Head	Observed in current calendar year	Floating Employee Day
December 31, 2021	Friday	New Year's Day
January 17	Monday	Martin Luther King Jr. Day
February 21	Monday	Presidents' Day
May 30	Monday	Memorial Day
June 20	Monday	Juneteenth
July 4	Monday	Independence Day
September 6	Monday	Labor Day
October 10	Monday	Columbus Day
November 11	Friday	Veterans' Day
November 24 & 25	Thursday & Friday	Thanksgiving Day
December 26	Monday	Christmas Day

DODGE COUNTY Clerks, Mayors, Chairpersons and Police Chiefs

<p>DODGE 68633 Chairman Leo E. Blaha Clerk Lori Kathol 402-693-2239</p> <p>FREMONT 68025 Mayor Joey Spellerberg Clerk Tyler Ficken Police Chief Jeff Elliott 402-727-2633</p> <p>HOOPER 68031 Mayor Bruce Cate Clerk Roxanne Meyer Police Chief Matt Schott 402-654-3649</p> <p>INGLEWOOD 68025 Chairman Albert Nielsen Clerk Barbara Shelton 402-721-3124</p> <p>NICKERSON 68044 Chairperson Rick Tucker Clerk Tina Doughy 402-727-7307</p>	<p>NORTH BEND 68649 Mayor Rod Scott Clerk Theresa Busse 402-652-3584</p> <p>SCRIBNER 68057 Mayor Ken Thomas Clerk Elmer Armstrong Police Chief Jake Brainard 402-664-3231</p> <p>SNYDER 68664 Chairman Joel D. Hunke Clerk Christine Sankey 402-568-2306</p> <p>UEHLING 68063 Chairman Dan Dallman Clerk Brenda Weitzenkamp (Served by City of Hooper) 402-567-2234</p> <p>WINSLOW 68072 Chairman Shawn Kotik Clerk Lisa Klein 402-719-4297</p>
---	--

Township Officials

Township Board - Cotterell	Steve Dvorak Maynard M. Flamme Greg Beebe	1260 Foothill Rd 1771 Hwy 79 155 Legge Lake	North Bend NE 68649 North Bend NE 68649 North Bend NE 68649
Township Board - Cuming	Kevin Hasemann Steven Ferguson Mark A. Langemeier	1546 Co. Rd. C Blvd 273 Co. Rd 19 1444 Co. Rd. E	Scribner NE 68057 Hooper NE 68031 Scribner NE 68057
Township Board - Elkhorn	Bryan Maschmeier Roxie Kracl Robert Reed	5685 Old Hwy 8 2821 S. County Road 26 6000 E. Military Ave.	Fremont NE 68025 Fremont NE 68025 Fremont NE 68025
Township Board - Everett	Glen Kassmeier Leonard D. Cassell	854 County Road 17 1670 County Road L	Hooper NE 68031 Hooper NE 68031
Township Board - Hooper	John H. Von Seggern Jr. Larry D. Klahn Garry E. Willnerd	2036 County Road H Blvd 201 E. Howard St., PO Box 236 429 N. Main St.	Hooper NE 68031 Hooper NE 68031 Hooper NE 68031
Township Board - Logan	Bob Weitzenkamp Brent Hilbers Douglas Egbers	1932 Co. Rd. D 2237 Co. Rd. C 326 Co. Rd. 24	Hooper NE 68031 Hooper NE 68031 Hooper NE 68031
Township Board - Maple	Luke Kardell Donald F. Paseka Alvin Kloke	1712 County Rd 16 1585 Co. Rd. 14 Blvd. 1532 Co. Rd. 13	Ames NE 68021 Ames NE 68621 Ames NE 68621

Township Board - Nickerson	Denise Richards Duane McKenzie Nancy O'Connor	1049 Skyline Drive 1575 Hwy 275 2108 County Road O	Fremont NE 68025 Fremont NE 68025 Fremont NE 68025
Township Board - Pebble	Russel Stockamp Daniel K. Beerbohm Jason P. Kreikemeier	1124 Co. Rd. G 666A County Road 8 125 Co. Rd. 8	Scribner NE 68057 Scribner NE 68057 West Point NE 68788
Township Board - Platte	Marlin Brabec Zachary C. Taylor Adam P. Taylor	1030 Timberwood Dr 3621 N. County Road 19 2020 Co. Rd. 14 Blvd	Ames, NE 68621 Fremont NE 68025 Ames NE 68621
Township Board - Pleasant Valley	Mark Holub Bernard Bunn Brad J. Harms	530 Co.Rd.H 958 Co. Rd. 4 937 Co.Rd. 3	Scribner NE 68057 Scribner NE 68057 Dodge NE 68633
Township Board - Ridgeley	Amanda Johnson Marvin J. Piper Stephen A. Helgenberger	1110 Co.Rd K 810 Co. Rd. 10 1142 Co. Rd. H	Scribner NE 68057 Scribner NE 68057 Scribner NE 68057
Township Board - Union	Chad M. Ruzicka Mark D. Flamme Randy G. Reznicek	1967 County Road 2 1640 Co. Rd 4, PO Box 413 1571 Co. Rd. 2	North Bend NE 68649 North Bend NE 68649 North Bend NE 68649
Township Board - Webster	Russell L. Hunke Tom Grovjohn	344 Co. Rd. F 433 Co. Rd. D	Dodge NE 68633 Dodge NE 68633

WHERE TO GO FOR:

Accidents, traffic..... Sheriff
Account of county Treasurer
Adoptions..... County Judge
Agricultural information Extension Agent
Alimony payments..... Clerk of District Court
Appeals court..... Clerk of District Court
Appointments of vacancies..... Board of Supervisors
Articles of Incorporation..... County Clerk
Assessment of cars..... Treasurer
Assessment of property Assessor
Assessment of farms and business Assessor
Auctions..... Sheriff
Bad checks County Attorney
Birth certificate, delayed County Judge
Board of Equalization Board of Supervisors
Bond coupons..... Treasurer
Bonds County Clerk
Boundary disputes Surveyor
Bridges Highway Superintendent
Budget approval..... Board of Supervisors
Budget information..... County Clerk
Burials County General Assistance
Child Support..... Clerk of District Court
Child Support..... Child Support Enforcement
Civil jurisdiction, under \$5000..... County Judge
Civil jurisdiction, \$5000-more Clerk of District Court
Claims (bills) approved..... Board of Supervisors
Claims (bills) processed County Clerk
Conservatorships County Judge
Counseling, juveniles Probation Office
Courthouse grounds, maintenance..... Bldg. Superintendent
Crimes County Attorney
Crippled Children's Services Social Services
Deeds Register of Deeds
Delinquent Tax collector..... Sheriff
Dockets, court..... Clerk of District Court
Driver's exams Driver's Examiners
Driver's license..... Treasurer
Easements..... Register of Deeds
Elections County Clerk
Exemptions, homestead, etc..... Assessor
Farming Extension Agent
Felonies, hearing County Judge
Felonies Clerk of District Court
Final decrees from probate Register of Deeds
Financial assistance..... Social Services

WHERE TO GO FOR:

Financing statements, Real Estate.....	Register of Deeds
Financing statements.....	County Clerk
Foods.....	Extension Agent
Forestry.....	Extension Agent
4-H.....	Extension Agent
Guardianships.....	County Judge
Highways.....	Highway Superintendent
Jail.....	Corrections Dept
Juvenile court.....	County Judge
Law enforcement.....	Sheriff
Leases.....	Register of Deeds
Levies.....	County Clerk
License plates.....	Treasurer
Liens, federal and state.....	Register of Deeds
Liens, automobile.....	Treasurer
Liquor licenses.....	County Clerk
Lis Pendens.....	Register of Deeds
Lost articles.....	Sheriff
Marriage, certificate.....	County Clerk
Marriage, dissolution (divorce).....	Clerk of District Court
Mental court.....	Clerk of District Court
Minutes of Board Action.....	County Clerk
Misdemeanors.....	County Judge
Mortgages.....	Register of Deeds
Passport applications.....	Clerk of District Court
Plats.....	Register of Deeds
Power of Attorney.....	Register of Deeds
Probate court.....	County Judge
Quarantines.....	Sheriff
Real estate.....	Register of Deeds
Relief funds.....	Social Services
Research, agricultural.....	Extension Agent
Revenue stamps.....	Register of Deeds
Roads.....	Highway Superintendent
Rural Schools Records.....	County Clerk
Salaries.....	Board of Supervisors
Securities.....	Treasurer
Services, relief	
Daycare	
Family planning	
Foster care	
Home delivered meals	
Housing improvements	
Transportation	
Special services for blind and	
Intellectually Disabled.....	Social Services

WHERE TO GO FOR:

Serving writs and orders.....	Sheriff
Settlements.....	Clerk of District Court
Small claims.....	County Judge
Surveys.....	Surveyor
Taxes, statements and payment.....	Treasurer
Titles, motor vehicle.....	Treasurer
Tobacco license.....	County Clerk
Traffic court.....	County Judge
Trusteeships.....	County Judge
Veterans.....	Veterans Service Officer
Veterans Discharge records.....	County Clerk
Vocational rehabilitation referral.....	Social Services
Voter registration.....	County Clerk
Warrants (checks) approved.....	Board of Supervisors
Warrants (checks).....	County Clerk
Wills (probate).....	County Judge

History to Remember!



On August 1, 1956, the burial of a capsule containing records of Fremont Centennial and other 100th anniversary articles was held. Fremonters were invited to attend. The capsule was welded airtight and encased in concrete before being dropped into its resting place near the courthouse steps, not to be dug up for 100 years.

VOTING QUALIFICATIONS

To qualify to register to vote you must be a resident of this county for at least 1 day prior to the Election and obtain the minimum age of 18 before the General Election date of any year. The only trick to this requirement is that the deadline for registering to vote at any election is 2 Fridays before the election. Once registered, the only time you would have to reregister would be if your name would change, your address would change, or you wish to change political party affiliation.



Congress passed the "Motor Vehicle Law" and was incorporated into State Law. You can also register at Drivers' Examiners, state and federal agencies, or by mail by calling our office for the forms. There may be voter registration forms in phone books or state income tax booklets or on the county's website at www.dodgecounty.nebraska.gov/ under County Offices and Election Commissioner. Mail-in registrations for new voters must be postmarked by the 3rd Friday prior to an election. The County Clerk can take registrations in office up until the 2nd Friday before elections.

POLLING PLACES

CITY OF NORTH BEND	VFW Hall
CITY OF SCRIBNER	Scribner City Community Room
COTTERELL/UNION/RIDGELEY/PLEASANT VALLEY	VFW Hall - North Bend
WEBSTER - DODGE	Dodge City Hall
PEBBLE - SNYDER	Snyder Auditorium
PLATTE EAST	Church of Christ, 4163 N Broad St.
PLATTE WEST	Christensen Field Community Rm. 1730 W. 16 th St.
NICKERSON/MAPLE	Nickerson Fireman's Community Rm
EVERETT/CUMING	Scribner City Community Room
CITY OF HOOPER	Hooper Public Library
LOGAN/HOOPER	Logan View Jr.-Sr. High
ELKHORN	First Lutheran Church, 3200 E. Military

POLLING PLACES (Continued)

FREMONT PRECINCTS

1A	Evangelical Free Church, 2050 N. Lincoln Ave.
1B	Midland Anderson Conference Center, 900 N. Clarkson St.
1C	First Lutheran Church, 3200 E. Military Ave.
1D	Gifford Tower, 2510 N. Clarkson
1E	St. Patrick's Catholic Church, 3400 E. 16th St.
2A	First Congregational Church, 1550 N. Broad St.
2B	Stone Bridge Christian Church, 1041 N. Nye Ave.
2C	Extension Service, 1206 W. 23rd
2D	Extension Service, 1206 W. 23rd
2E	Extension Service, 1206 W. 23rd
3A	Metro Community College (West Entrance)
3B	Courthouse, 5th & Park
3C	old ENCOR Bldg., 935 S Schneider
3D	Christensen Field Comm. Rm, 1730 W. 16th St.
3E	Salem Lutheran Church, 401 E. Military
4A	Good Shepherd Lutheran Church, 1544 E. Military Ave.
4B	Good Shepherd Lutheran Church, 1544 E. Military Ave.
4C	Deerfield Clubhouse, 1021 S. Howard Dr.
4D	First Lutheran Church, 3200 E. Military Ave.
4E	Swanson Hall of Science, 8th & Irving

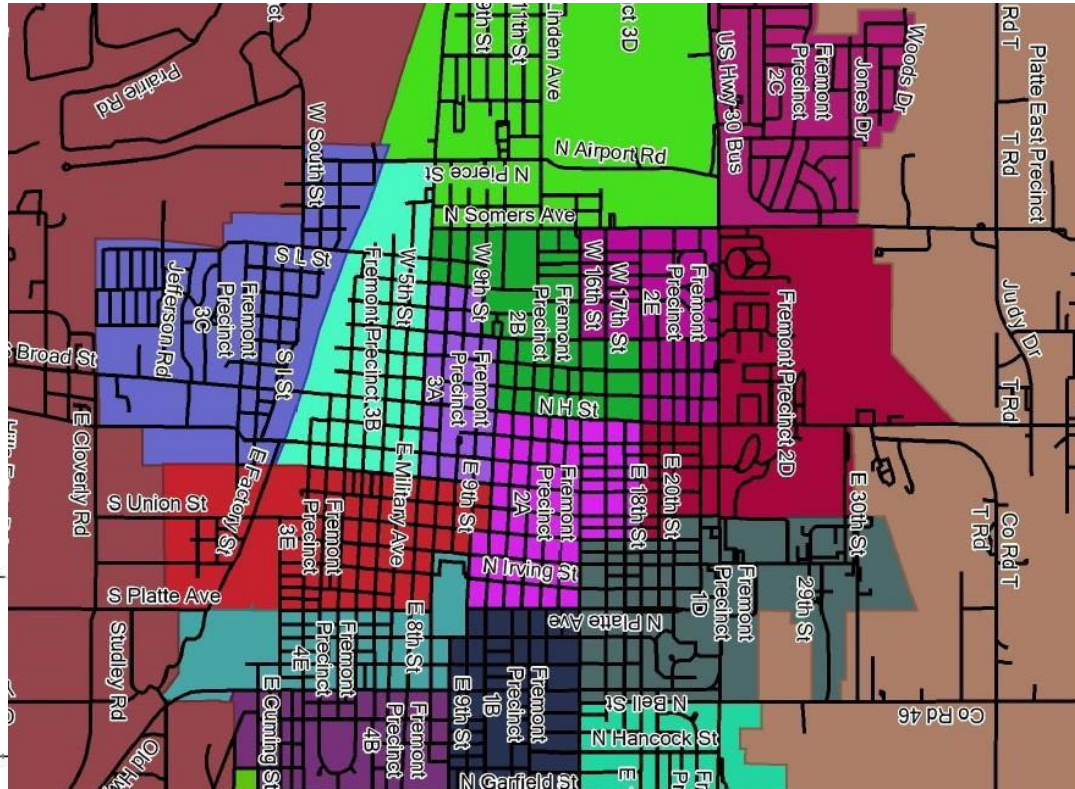

CITY OF FREMONT VOTING PRECINCTS

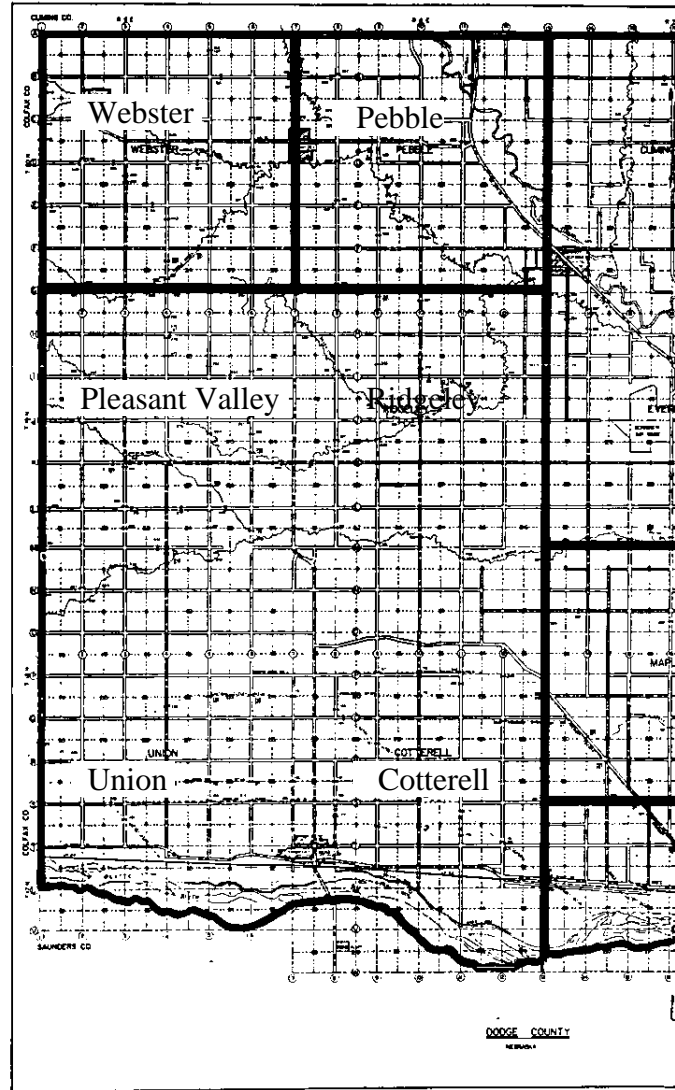
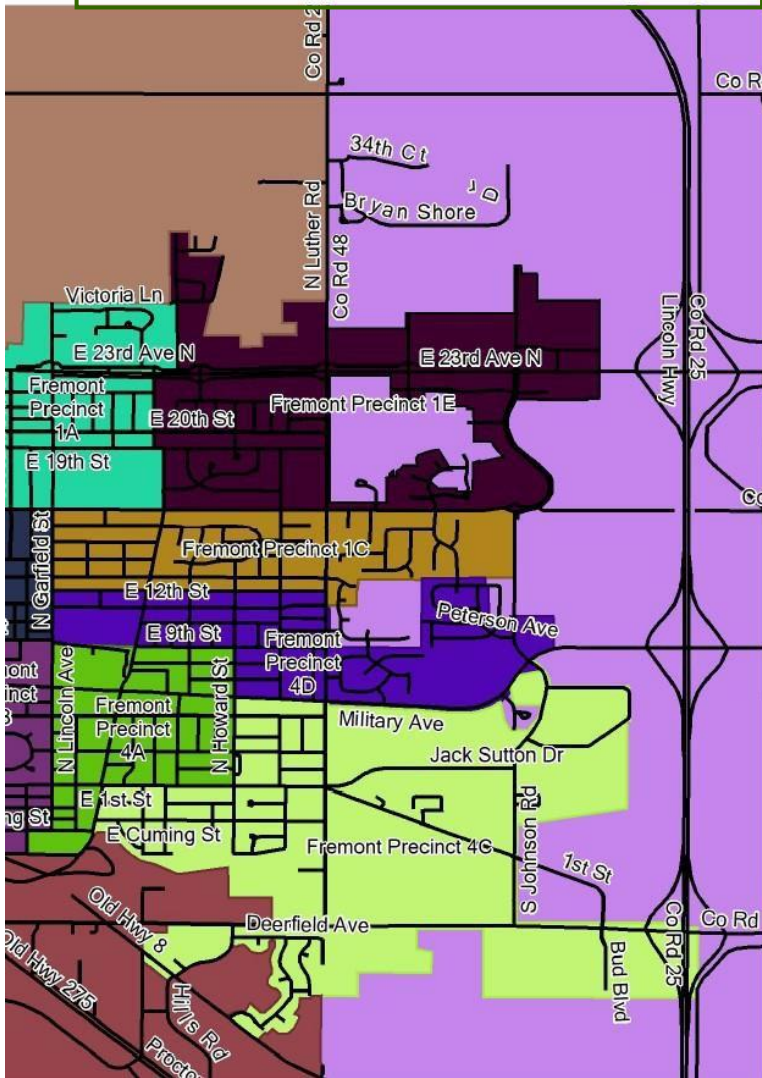

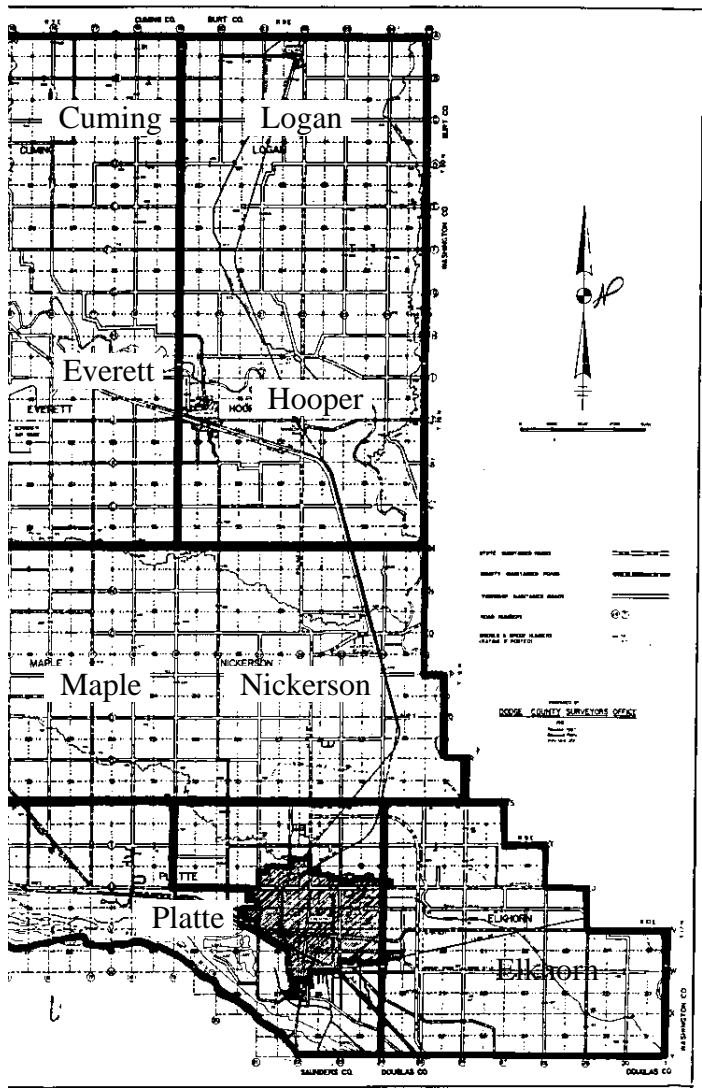

TAX SECTION

An effort to clarify the County Budget and to list all other property taxes that Dodge County citizens are required to pay for the services of the different political subdivisions.

Step 1
To estimating the Budget, sometimes it helps to see where you've been ...

Explanation of Funds

- Road – expenses for roads/bridges
- Inheritance- expenses using Inheritance Taxes
- Interest - expenses using investments
- Relief Funds - expenses for indigents, veterans' aid, institutions, and general assistance program
- Miscellaneous Funds – include flood control, historical society, visitors promotion, 911 system, and other grants

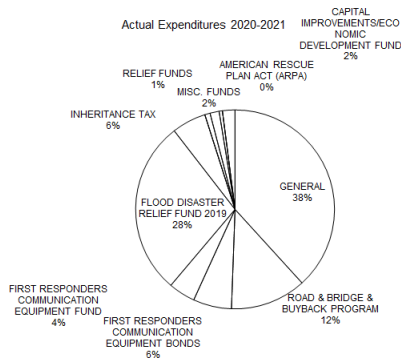

Actual Expenditures 2020-2021	
GENERAL	12,475,133
ROAD & BRIDGE & BUYBACK PROGRAM	4,026,403
FIRST RESPONDERS COMMUNICATION EQUIPMENT BONDS	2,035,479
FIRST RESPONDERS COMMUNICATION EQUIPMENT FUND	1,423,760
FLOOD DISASTER RELIEF FUND 2019	9,239,673
INHERITANCE TAX	1,816,722
INTEREST FUND	-
RELIEF FUNDS	283,453
MISC. FUNDS	483,358
BUILDING FUND	173,789
AMERICAN RESCUE PLAN ACT (ARPA)	-
CAPITAL IMPROVEMENTS/ECONOMIC DEVELOPMENT FUND	666,667
TOTAL	32,624,436

23

Step 2— Estimate your anticipated expenditures for the year....

Budgeted Expenditures 2021-2022

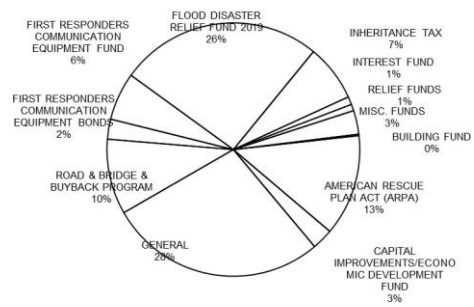

Budgeted Expenditures 2021-2022	
GENERAL	15,268,749
ROAD & BRIDGE & BUYBACK PROGRAM	5,283,161
FIRST RESPONDERS COMMUNICATION EQUIPMENT BONDS	1,400,142
FIRST RESPONDERS COMMUNICATION EQUIPMENT FUND	3,355,000
FLOOD DISASTER RELIEF FUND 2019	14,247,582
INHERITANCE TAX	3,981,756
INTEREST FUND	558,115
RELIEF FUNDS	456,020
MISC. FUNDS	1,668,412
BUILDING FUND	100,781
AMERICAN RESCUE PLAN ACT (ARPA)	7,102,323
CAPITAL IMPROVEMENTS/ECONOMIC DEVELOPMENT FUND	1,491,122
TOTAL	54,913,163

24

Step 2

This is just a closer look at the General Fund
 WAGES – all wages, OFFICE OPERATIONS – expenses to run offices, CAPITAL OUTLAY – new equipment, RETIREMENT – INCLUDES Social Security, Workmen's compensation, retirement, health, and unemployment, JAIL, BLDG. & GROUNDS – expenses related to the Corrections Facility and building/grounds upkeep, AGENCIES – includes water rescue, emergency mgmt., ENOA, ENOR, Fremont Area Industrial Development, & firemen's training &

GENERAL FUND BUDGET Anticipated Expenditures - 2021-2022

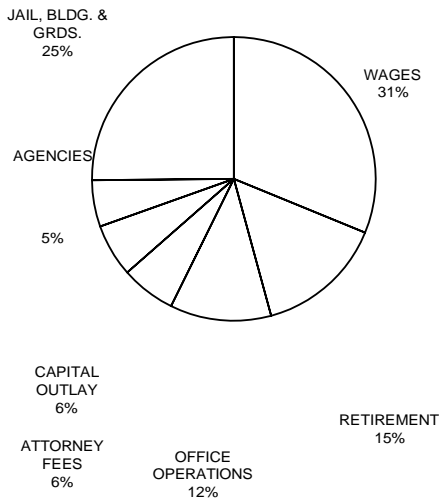

GENERAL FUND BUDGET		
Anticipated Expenditures - 2021-2022		
WAGES		\$4,737,105
RETIREMENT		2,214,000
OFFICE OPERATIONS		1,751,682
ATTORNEY FEES		948,000
CAPITAL OUTLAY		914,342
AGENCIES		805,665
JAIL, BLDG. & GRDS.		3,819,750
PROBATION OFFICE BONDS		78,205

TOTAL		\$15,268,749

Step 3

To find out how to pay for the expenditures, you must look at revenues. The first source of income is cash on hand....

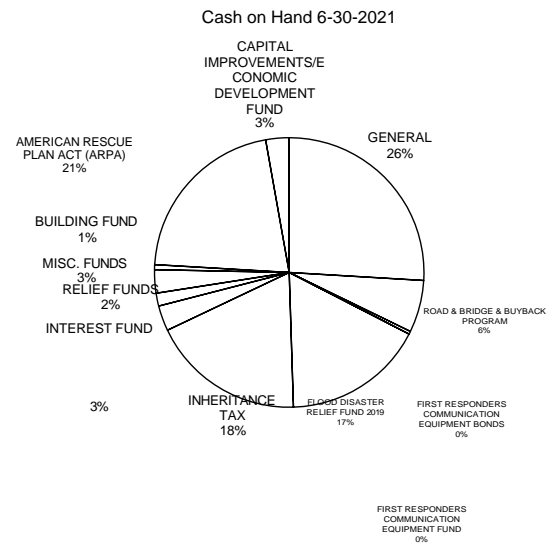

Cash on Hand 6-30-2021	
GENERAL	4,333,637
ROAD & BRIDGE & BUYBACK PROGRAM	1,044,842
FIRST RESPONDERS COMMUNICATION EQUIPMENT BONDS	60,072
FIRST RESPONDERS COMMUNICATION EQUIPMENT FUND	147
FLOOD DISASTER RELIEF FUND 2019	2,830,453
INHERITANCE TAX	3,081,756
INTEREST FUND	508,115
RELIEF FUNDS	257,137
MISC. FUNDS	468,125
BUILDING FUND	100,281
AMERICAN RESCUE PLAN ACT (ARPA)	3,551,161
CAPITAL IMPROVEMENTS/ECONOMIC DEVELOPMENT FUND	468,722
TOTAL	16,704,448

Step 4

Estimate other sources of income besides property taxes....

Anticipated Miscellaneous Collections 2021-2022

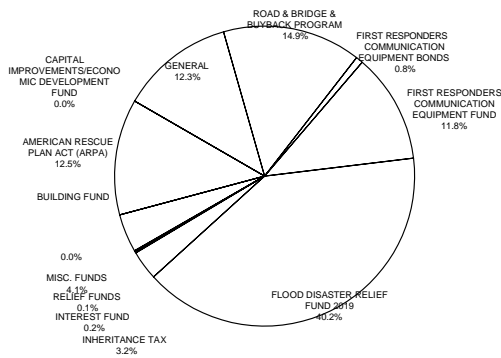

Anticipated Miscellaneous Collections 2021-2022	
GENERAL	3,483,900
ROAD & BRIDGE & BUYBACK PROGRAM	4,238,319
FIRST RESPONDERS COMMUNICATION EQUIPMENT BONDS	217,400
FIRST RESPONDERS COMMUNICATION EQUIPMENT FUND	3,354,853
FLOOD DISASTER RELIEF FUND 2019	11,417,129
INHERITANCE TAX	900,000
INTEREST FUND	50,000
RELIEF FUNDS	27,295
MISC. FUNDS	1,171,646
BUILDING FUND	500
AMERICAN RESCUE PLAN ACT (ARPA)	3,551,162
CAPITAL IMPROVEMENTS/ECONOMIC DEVELOPMENT FUND	-
TOTAL	28,412,204

Step 5

PROPERTY TAX REQUIREMENT

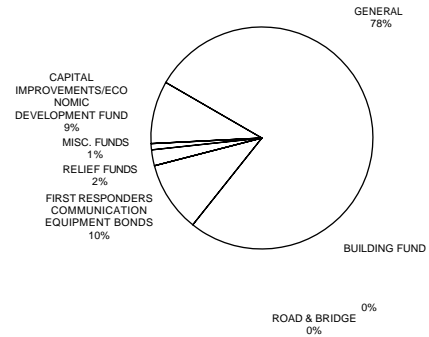

FISCAL YEAR 2021-2022 DODGE COUNTY BUDGET	
PROPERTY TAX REQUIREMENT (based on a valuation of \$4,755,492,614)	
GENERAL	.177715
FIRST RESPONDERS COMMUNICATION EQUIPMENT BONDS	.023608
ROAD & BRIDGE	.000000
RELIEF FUNDS	.005312
MISC. FUNDS	.002068
BUILDING FUND	.000000
CAPITAL IMPROVEMENTS/ECONOMIC DEVELOPMENT FUND	.021027
TOTAL	.229730

To recap the 2021-2022 County Budget
WHERE THE MONEY GOES...

FUND	OPERATING	CASH RESERVE	TOTAL
GENERAL	15,268,749	\$1,000,000	16,268,749
ROAD & BRIDGE & BUYBACK PROGRAM	\$5,283,161	\$0	5,283,161
FIRST RESPONDERS COMMUNICATION EQUIPMENT BONDS	\$1,400,142	\$0	1,400,142
FIRST RESPONDERS COMMUNICATION EQUIPMENT FUND	\$3,355,000	\$0	3,355,000
FLOOD DISASTER RELIEF FUND 2019	\$14,247,582	\$0	14,247,582
INHERITANCE TAX	\$3,981,756	\$0	3,981,756
INTEREST FUND	\$558,115	\$0	558,115
RELIEF FUNDS	\$456,020	\$81,000	537,020
MISC. FUNDS	\$1,668,412	\$69,702	1,738,114
BUILDING FUND	\$100,781	\$0	100,781
AMERICAN RESCUE PLAN ACT (ARPA)	\$7,102,323	\$0	7,102,323
CAPITAL IMPROVEMENTS/ECONOMIC DEVELOPMENT FUND	1,491,122	-	1,491,122
TOTAL	54,913,163	\$1,150,702	56,063,865

29

30

WHERE THE MONEY COMES FROM....



SOURCES	REVENUES					
	Funds and Percentages from various sources					
	General	Percent of Revenues	Road	Percent of Revenues	Building Fund	Percent of Revenues
Cash on Hand	4,333,637	27%	1,044,842	20%	100,281	100%
Federal	\$0	0%	\$0	0%	\$0	0%
State	\$138,000	1%	\$2,959,729	56%	\$450	0%
Local	\$3,345,900	21%	\$1,278,590	24%	\$50	0%
Property Taxes	\$8,451,212	52%	-	0%	-	0%
TOTALS	16,268,749	100%	5,283,161	100%	100,781	100%
	Relief Funds	Percent of Revenues	Interest Fund	Percent of Revenues	Inheritance Tax	Percent of Revenues
Cash on Hand	257,137	48%	508,115	91%	3,081,756	77%
Federal	\$0	0%	\$0	0%	\$0	0%
State	\$11,800	2%	\$0	0%	\$0	0%
Local	\$15,494	3%	\$50,000	9%	\$900,000	23%
Property Taxes	252,589	47%	\$0	0%	\$0	0%
TOTALS	537,020	100%	558,115	100%	3,981,756	100%

	Miscellaneous	Percent of	Capital Improvements	Percent of	First Responders	Percent of
	Funds	Revenues	Economic Development	Revenues	Communication Equipment Bonds	Revenues
Cash on Hand	468,125	27%	468,722	31%	60,072	4%
Federal	\$490,000	28%	-	0%	\$0	0%
State	\$4,300	0%	\$21,400	1%	\$16,400	1%
Local	\$677,347	39%	\$1,000	0%	\$201,000	15%
Property Taxes	98,342	6%	1,000,000	67%	1,122,670	80%
TOTALS	1,738,114	100%	1,491,122	100%	1,400,142	100%
	First Responders	Percent of	Flood Disaster	Percent of	Total	Percent of
	Equipment Fund	Revenues	ARPA	Revenues	All Funds	Revenues
Cash on Hand	147	0%	6,381,615	30%	\$16,704,448	30%
Federal	\$0	0%	9,968,291	47%	\$10,458,291	19%
State	\$0	0%	-	0%	\$3,152,079	6%
Local	\$3,354,853	100%	5,000,000	23%	\$14,824,234	26%
Property Taxes	-	0%	-	0%	\$10,924,813	19%
TOTALS	3,355,000	100%	21,349,905	100%	\$56,063,865	100%

HOW TO FIGURE YOUR TAXES

CHECKLIST:

- Check what taxable districts your residence lies in.
- Obtain the total Consolidated Tax Levy by adding the levies of each taxable district of your residence.
- Check the Assessed Value of the property, business, or motor vehicle to see if it is accurate.
- Divide the amount of Assessed Value by 100 and then multiply the answer by the consolidated tax levy-the final answer is your tax.
- Check for exemptions and subtract the exemption credits.
- Now, think about how to pay for them at the treasurer's office or on-line at <https://dodge.gworks.com/> (If paying on-line, click on the \$ sign and enter your name, parcel # or

EXAMPLE:

Suppose I live in the City Limits of Fremont and the Assessed Value of my property is \$100,000. Assume a Homestead Exemption of \$30,000.

1-The taxing districts are the following:

District	Levy (\$s/\$100)
City of Fremont	.325875
School District No. 1	1.223161
Educational Service Unit No. Two	.015000
Metropolitan Technical College	.095000
Dodge County	.229730
Lower Platte North Natural Resources District	.033450
Dodge County Agricultural Society	.002387
2-Total Consolidated Levy	1.924603

3-My assessed value of my property looks accurate.

4-Since levies are listed in cents per \$100 of assessed property, I must divide the property value by \$100. Assessed property divided by 100:

100,000/100 equals 1,000
 Total Consolidated Tax levy multiplied by the number of each \$100 of property:
 1.924603 times 1,000 equals \$1,924.60, the taxes due.

5-State Tax Credit of .0010221 of \$100,000 value = \$102.21
 6-I have a homestead exemption of \$30,000. So, I must repeat the process to obtain my tax credit:
 30,000/100 equals 300
 1.924603 times 300 equals \$577.38, the tax credit.

Taxes	\$1,924.60
- State Tax credit	-102.21
- Homestead Exemption credit	<u>-577.38</u>
Adjusted Taxes Due	\$1,245.01

6-Now, I go to the Treasurer's Office or on-line and pay my taxes.

ITEMIZED FINAL LEVIES FOR PROPERTY IN CITIES AND VILLAGES 2021													
City/Village	County	School	JPA Pathways to Tomorrow	ESU	Community College	Township	Fire District	Natural Resources District	City/Village	Agricultural Society	TOTAL	Last Year's Levy	Difference
Fremont	.229730	1.223161		.015000	.095000			.033450	.325875	.002387	1.924603	1.940584	-0159810
North Bend	.229730	.7506002		.015000	.095000		.038880	.033450	.449998	.002387	1.620447	1.643976	-0235290
Scribner Hooper	.229730	.754396		.015000	.095000			.023236	.449996	.002387	1.569745	1.574432	-0046870
Most of Hooper	.229730	.777029		.015000	.095000	.064274	.066139	.023236	.741209	.002387	2.014004	2.171438	-1574340
Brickyard Sub	.229730	.777029		.015000	.095000	.070432	.066139	.023236	.741209	.002387	2.020162	2.178593	-1584310
Dodge	.229730	.594867	.005570	.015000	.095000	.066073		.023236	.499998	.002387	1.531861	1.537227	-0053662
Inglewood	.229730	1.223161		.015000	.095000	.040083	.053597	.033450	.262931	.002387	1.955336	2.011457	-0561183
Nickerson	.229730	.777029		.015000	.095000	.075449	.029831	.023236	.449993	.002387	1.697655	1.788694	-0910390
Snyder													
West of Main	.229730	.754396		.015000	.095000	.066073		.023236	.499998	.002387	1.685820	1.694848	-0090280
East of Main	.229730	.754396		.015000	.095000	.075936		.023236	.499998	.002387	1.695683	1.703919	-0082360
Uehling	.229730	.777029		.015000	.095000	.081519	.033517	.023236	.416965	.002387	1.674383	1.811566	-1371830
Winslow	.229730	.777029		.015000	.095000	.064274	.033031	.023236	2.250142	.002387	3.489825	3.562855	-0730260
LB 1114 Targets													
limit in 1998-01	0.500000	1.100000		0.015000	0.080000	*	*	0.045000	0.450000	*	2.190000		
limit in 2001-02	0.500000	1.000000		0.015000	0.070000	*	*	0.045000	0.450000	*	2.080000		
changed in 2003	0.500000	1.050000		0.015000	0.070000	*	*	0.045000	0.450000	*	2.130000		
*15 cents of the county's maximum levy may go to support these subdivisions.													
5 cents of the county's maximum levy may fund Interlocal Cooperative Agreements													

LB 1114 was passed by the Legislature in 1995 with strict limits on property taxes. It allows additional taxes for bonded indebtedness, items under the Interlocal Cooperative Agreement Act, voluntary retirements, certain projects, and judgments and additional amounts approved by voters.

DODGE COUNTY, CITY & VILLAGE LEVIES

FUND/SUBDIVISION	2021 VALUATION	2021 TAX REQUEST	2021 LEVY
Statutory levy limits: 45 cents + 5 cents interlocal agreements debt service or special levies are not included.			
FREMONT - CITY OF CLASS I			
All Purposes	\$1,946,334,530	\$5,827,509	0.299409
Special Levies	\$1,946,334,530	included above	
Debt	\$1,946,334,530	\$515,117	0.026466
TOTAL	\$1,946,334,530	\$6,342,626	0.325875
NORTH BEND - CITY OF CLASS II			
All purposes	\$94,271,346	\$424,219	0.449998
SCRIBNER - CITY OF CLASS II			
All purposes	\$47,025,928	\$211,615	0.449996
HOOPER - CITY OF CLASS II			
Hooper - Hooper Twp	\$47,732,619		
Hooper - Everett Twp	\$4,183,355		
Total	\$51,915,974		
All purposes certified	\$53,906,397	\$242,579	0.450000
Bonds	\$53,906,397	\$156,980	0.291209
TOTAL	\$53,906,397	\$399,559	0.741209
VILLAGES			*set by city
DODGE			
All purposes	\$27,069,499	\$135,347	0.499998
Equipment Sinking	\$27,069,499		0.000000
TOTAL	\$27,069,499	\$135,347	0.499998
INGLEWOOD			
All purposes	\$23,393,573	\$17,069	0.072964
Bonds	\$23,393,573	\$44,440	0.189967
TOTAL	\$23,393,573	\$61,509	0.262931
NICKERSON			
All purposes	\$9,129,035	\$41,080	0.449993
SNYDER			
Snyder - Pebble Twp	\$13,700,131		
Snyder - Webster Twp	\$4,255,748		
Total	\$17,955,879		
All purposes - Certified	\$17,549,465	\$87,747	0.499998
Bonds	\$17,549,465		
TOTAL	\$17,549,465	\$87,747	0.499998
UEHLING			
All purposes	\$11,991,401	\$30,000	0.250179
Debt & special levies	\$11,991,401	\$20,000	0.166786
TOTAL	\$11,991,401	\$50,000	0.416965
WINSLOW			
All purposes	\$2,138,709	\$9,624	0.449991

35

TOWNSHIP LEVIES

FUND/SUBDIVISION	2021 VALUATION	2021 TAX REQUEST	2021 LEVY
Statutory levy limit: \$.28 cents/\$100 for all purposes but part of county's 15 cents			
UNION			
Road	\$218,767,277	\$212,696	0.097225
PLEASANT VALLEY			
Road	\$153,412,565	\$141,671	0.092346
WEBSTER			
Total	\$189,772,929		
less Dodge	\$27,069,499		
less Snyder	\$4,255,748		
Rural	\$158,447,682		
50% of Dodge	\$13,534,750		
50% of Snyder	\$2,127,874		
Road	\$174,110,306	\$115,040	0.066073
COTTERELL			
Road	\$225,600,982	\$219,340	0.097225
RIDGELEY			
Road	\$153,311,939	\$84,391	0.055045
PEBBLE			
Total	\$143,531,853		
less Snyder	\$13,700,131		
Rural	\$129,831,722		
50 % of Snyder	\$6,850,066		
Road	\$136,681,788	\$103,790	0.075936
PLATTE			
Total	\$482,464,775		
less Inglewood	\$23,393,573		
Rural	\$459,071,202		
50 % of Inglewood	\$11,696,787		
Road	\$470,767,989	\$188,700	0.040083

36

TOWNSHIP LEVIES (cont.)

FUND/SUBDIVISION	2021 VALUATION	2021 TAX REQUEST	2021 LEVY
MAPLE			
Road	\$138,860,956	\$135,005	0.097223
EVERETT			
Total	\$138,222,855		
Less Hooper	\$4,183,355		
Rural	\$134,039,500		
50% of Hooper	\$2,091,678		
Road	\$136,131,178	\$95,880	0.070432
CUMING			
Road	\$154,453,838	\$149,407	0.096732
NICKERSON			
Total	\$182,501,985		
less Nickerson	\$9,129,035		
Rural	\$173,372,950		
50 % of Nickerson	\$4,564,518		
Road	\$177,937,468	\$134,252	0.075449
HOOPER			
Total	\$186,195,617		
Less Hooper	\$47,732,619		
Less Winslow	\$2,138,709		
Rural	\$136,324,289		
50% of Hooper	\$23,866,310		
50% of Winslow	\$1,069,355		
Road	\$161,259,954	\$103,649	0.064274
LOGAN			
Total	\$162,213,493		
less Uehling	\$11,991,401		
Rural	\$150,222,092		
50 % of Uehling	\$5,995,701		
Road	\$156,217,793	\$127,347	0.081519
TOTAL	\$156,217,793	\$127,347	0.081519
ELKHORN			
Road	\$148,487,302	\$153,000	0.097225
			*set at county max

RURAL FIRE PROTECTION DISTRICT LEVIES

FUND/SUBDIVISION	2021 VALUATION	2021 TAX REQUEST	2021 LEVY
RURAL FIRE PROTECTION DISTRICTS			
Statutory levy limit - General: \$.070 cents/\$100; Sinking: \$.105 cents/\$100 but part of county's 15 cents			
1 NICKERSON			
Dodge County	\$252,173,073		
Washington County	\$84,645,436		
General	\$336,818,509	\$70,122	0.020819
Bonds	\$336,818,509	\$30,353	0.009012
TOTAL	\$336,818,509	\$100,475	0.029831
2 HOOPER			
General	\$248,088,718	\$150,000	0.048000
Sinking	\$248,088,718		0.000000
Bonds	\$248,088,718	\$45,000	0.018139
TOTAL	\$248,088,718	\$195,000	0.066139
			*General reduced to county limit
3 SCRIBNER			
General	\$360,614,245	\$115,395	0.032000
Sinking			
Bonds	\$360,614,245	\$35,233	0.009770
TOTAL	\$360,614,245	\$150,628	0.041770
4 DODGE			
Dodge County	\$156,221,237		
Colfax County	\$47,992,319		
Cuming County	\$142,801,449		
General	\$347,015,005	\$83,070	0.023938
5 SNYDER			
Dodge County	\$229,008,165		
Cuming County	\$26,670,230		
General	\$255,678,395	\$67,586	0.026434

RURAL FIRE PROTECTION DISTRICT LEVIES (cont.)

FUND/SUBDIVISION	2021 VALUATION	2021 TAX REQUEST	2021 LEVY
6 UEHLING			
Dodge County	\$147,586,682		
Burt County	\$103,416,356		
Cuming County	\$44,967,947		
Washington County	\$8,034,031		
General	\$304,005,016	\$101,893	0.033517
Bonds	\$304,005,016	\$0	0.000000
Total	\$304,005,016	\$101,893	0.033517
7 WINSLOW			
Dodge County	\$107,118,254		
Washington County	\$110,007,191		
General	\$217,125,445	\$71,718	0.033031
Bonds	\$217,125,445	\$0	0.000000
TOTAL	\$217,125,445	\$71,718	0.033031
8 FREMONT			
Dodge County	\$630,990,026		
Saunders County	\$3,605,682		
General	\$634,595,708	\$172,941	0.027252
Bonds	\$634,595,708	\$167,187	0.026345
TOTAL	\$634,595,708	\$340,128	0.053597
9 NORTH BEND			
Dodge County	\$585,712,791		
Saunders County	\$4,243,906		
General	\$589,956,697	\$141,593	0.024001
Bonds	\$589,956,697	\$87,780	0.014879
TOTAL	\$589,956,697	\$229,373	0.038880

MISCELLANEOUS SUBDIVISION LEVIES

FUND/SUBDIVISION	2021 VALUATION	2021 TAX REQUEST	2021 LEVY
TECH COLLEGE			
max of the Community College Foundation and Equalization Aid Act			
Metropolitan Technical Community College			
General	\$81,434,277,028	\$61,075,708	0.075000
Sinking	\$81,434,277,028	\$16,286,855	0.020000
Hazardous material abatement & handicapped accessibility fund	\$81,434,277,028	\$0	
TOTAL	\$81,434,277,028	\$77,362,563	0.095000
EDUCATIONAL SERVICE UNITS			
1.5 cents max			
ESU # 2 - Most of Dodge County			
Burt County	\$1,788,139,212		
Butler County	\$844,995		
Cass County	\$266,232,726		
Collfax County	\$4,706,837		
Cuming County	\$2,368,208,750		
Dodge County	\$4,485,464,083		
Douglas County	\$46,059,045		
Lancaster County	\$450,726,302		
Sarpy County	\$832,710		
Saunders County	\$3,942,146,891		
Seward County	\$10,191,086		
Stanton County	\$270,175,409		
Thurston County	\$169,145,899		
Washington County	\$293,864,878		
Wayne County	\$22,185,856		
General	\$14,118,924,679	\$2,117,839	0.015000
Bonds	\$14,118,924,679	\$0	0.000000
Total	\$14,118,924,679	\$2,117,839	0.015000
ESU # 3 - Fraction 24			
General	\$52,838,881,098	\$7,925,832	0.015000
Telecomputing	\$52,838,881,098		
Total	\$52,838,881,098	\$7,925,832	0.015000
ESU # 7 - Dodge Howells Schools			
General	\$17,766,427,212	\$2,664,964	0.015000
Bonds	\$17,766,427,212	\$0	0.000000
Total	\$17,766,427,212	\$2,664,964	0.015000
JOINT PUBLIC AGENCIES			
Pathways 2 Tomorrow			
Burt County	\$1,012,363,109		
Collfax County	\$259,671,887		
Cuming County	\$1,895,584,237		
Dakota County	\$225,621,538		
Dixon County	\$107,999,045		
Dodge County	\$220,685,864		
Stanton County	\$68,486,462		
Thurston County	\$282,944,025		
Wayne County	\$0		
General	\$4,073,356,167	\$226,878	0.005570

MISCELLANEOUS SUBDIVISION LEVIES (cont.)

FUND/SUBDIVISION	2021 VALUATION	2021 TAX REQUEST	2021 LEVY
NATURAL RESOURCES DISTRICTS			
4.5 cents max			
Lower Platte North NRD - southern county			
General	\$10,406,030,147	\$3,480,715	0.033450
Sinking	\$10,406,030,147		0.000000
Total	\$10,406,030,147	\$3,480,715	0.033450
Lower Elkhorn NRD - northern county			
General	\$18,859,137,296	\$4,382,016	0.023236
Papio NRD - small part s.e. of Fremont			
General	\$79,989,158,381	\$23,678,925	0.029603
Bonds	\$79,989,158,381	\$4,852,166	0.006066
Total	\$79,989,158,381	\$28,531,091	0.035669
AGRICULTURAL SOCIETIES			
part of county's 15 cents max			
Dodge County Agricultural Society			
General	\$4,755,492,614	\$113,537	0.002387
Bonds	\$4,755,492,614		
Total	\$4,755,492,614	\$113,537	0.002387
SANITARY & IMPROVEMENT DISTRICTS			
5 years or older 40 cent max			
under 5 years no max			
SID # 2 - Sunset Addition			
General	\$19,488,226	\$11,261	0.057784
Bonds	\$19,488,226	\$96,390	0.494606
Total	\$19,488,226	\$107,651	0.552390
SID # 3 - Lake Ventura			
General	\$48,371,466	\$193,485	0.399988
Bonds	\$48,371,466	\$41,212	0.085199
Total	\$48,371,466	\$234,697	0.485197
SID # 4 - Roadway Subdivision dissolved and annexed into the City of Fremont			
General			
Bond Investment Fund			
Total			
SID # 5 - Timberwood Subdivision			
General	\$15,243,026	\$34,729	0.227835
SID # 6 - Sapp Brothers Subdivision			
General	\$4,212,976	\$16,852	0.400000
Bonds	\$4,212,976	\$54,769	1.300007
Total	\$4,212,976	\$71,621	1.700007
SID #7 - Oliver Subdivision (created in 1999)			
		*general lowered to state law limit	

SCHOOL DISTRICT LEVIES

FUND/SUBDIVISION	2021 VALUATION	2021 TAX REQUEST	2021 LEVY
SCHOOL DISTRICTS			
max of \$1.05 General Fund			
1- FREMONT			
K-8 BONDS			
Original #1 (K-8 Bonds)	\$2,441,832,408		
J42-J51 Douglas County	\$46,059,045		
Saunders County K-8	\$29,416,694		
Total for K-8 2000 bonds	\$2,517,308,147	\$2,223,502	0.109976
9-12 BONDS			
Original #1 (9-12 Bonds)	\$2,491,573,069		
J42-J51 Douglas County	\$46,059,045		
old Saunders County Dist 11	\$104,723,237		
Total for 9-12 2000 bonds	\$2,642,355,351	\$71,218	0.003396
OTHER FUNDS:			
Original #1	\$2,491,573,069		
J42-J51 Douglas County	\$46,059,045		
old Saunders County Dist 11	\$285,597,142		
Building Fund	\$2,823,229,256	\$495,527	0.017552
General	\$2,823,229,256	\$29,579,594	1.047722
Build America Bond 1 (new 5/6 school)	\$2,491,573,069	\$834,901	0.029569
Build America Bond 2 (Elementaries Reno)	\$2,491,573,069	\$422,011	0.014946
TOTAL	\$2,823,229,256	\$33,626,753	1.223161
RECAP OF FREMONT SCHOOLS			
All areas except Saunders & Brugh			1.223161
Saunders - old #105 (+ new bonds)			1.223161
Saunders - #11 (just General & 9-12 Asbestos/Bonds)			1.051118
Saunders - #11 (just General & Building)			1.065274
Brugh - General & 9-12 Bonds + Building)			1.068670

SCHOOL DISTRICT LEVIES (cont.)

FUND/SUBDIVISION	2021 VALUATION	2021 TAX REQUEST	2021 LEVY
62 SCRIBNER/SNYDER PUBLIC SCHOOLS			
Cuming County	\$6,786,881		
Dodge County	\$498,451,993		
Special Building	\$505,238,874	\$151,515	0.029989
Total for General	\$505,238,874	\$3,659,988	0.724407
TOTAL	\$505,238,874	\$3,811,503	0.754396
94 LOGAN VIEW PUBLIC SCHOOLS			
Burt County	\$69,446,336		
Dodge County	\$674,226,081		
Washington County	\$137,875,847		
Cuming County	\$12,368,920		
Special Building	\$893,917,184	\$434,949	0.048657
General	\$893,917,184	\$5,912,248	0.661387
Bonds	\$893,917,184	\$598,788	0.066985
TOTAL	\$893,917,184	\$6,945,985	0.777029
95 - NORTH BEND CENTRAL PUBLIC SCHOOLS			
Dodge County	\$819,422,549		
Saunders County	\$289,201,218		
Coffax County	\$4,706,837		
Special Building	\$1,113,330,604	\$832,323	0.074760
Qualified Capital Purpose Undertaking Fun	\$1,113,330,604	\$227,273	0.020414
Bonds voted on 3/12/13	\$1,113,330,604	\$398,990	0.035838
General	\$1,113,330,604	\$6,958,204	0.624990
TOTAL	\$1,113,330,604	\$8,416,790	0.756002
OTHER COUNTY LEVIES WHOSE TERRITORY COMES INTO DODGE COUNTY			
West Point Schools			
General	\$991,189		0.660066
Special Building	\$991,189		0.007301
Bond	\$991,189		0.043204
Total	\$991,189		0.710571
Arlington Public Schools			
General	\$51,133,060		0.762402
Special Building	\$51,133,060		0.133672
Qualified Capital Improvement Fund	\$51,133,060		0.051832
Bond	\$51,133,060		0.047740
Total	\$51,133,060		0.995646
Fraction 14 with Burt County - Oakland-Craig Schools			
General	\$799,203		0.956908
Qualified Capital Improvement Fund	\$799,203		0.000000
Bond	\$799,203		0.080707
Special Building Fund	\$799,203		0.010187
Total	\$799,203		1.047802
Howells-Dodge Unified Schools			
General	\$218,895,472		0.534368
Special Building	\$218,895,472		0.060499
Bond (old Dodge District not obligated to H	\$218,895,472		0.000000

HISTORICAL FACTS

Dodge County organized, March 15, 1855
 Fremont Incorporated, 1859, declared county seat, 1860
 North Bend Incorporated, 1876
 Hooper Incorporated, 1876
 Scribner Incorporated, 1881
 Dodge Incorporated, 1887
 Snyder Incorporated, 1890
 Uehling Incorporated, 1909
 Nickerson Incorporated, 1910
 Inglewood Incorporated, 1959 (7-22-59)
 Winslow Incorporated, 1909

Nebraska admitted to statehood March 1, 1867, and contains 76,808 square miles (of which 712 square miles are water).

DODGE COUNTY CENSUS INFORMATION

Subdivision	1990	2000	2010	2020	%Change
Cotterell Township	428	400	403	361	-10.4%
Cuming Township	285	251	241	219	-9.1%
Elkhorn Township	425	416	377	329	-12.7%
Everett Township	250	253	220	218	-0.9%
City of Fremont	24	25,174	26,397	27,141	2.8%
Hooper Township	1,285	1,302	1,275	1,130	-11.4%
City of Hooper	850	827	830	857	3.3%
Village of Winslow	140	104	103	19	-81.6%
Logan Township	536	534	433	463	6.9%
Village of Uehling	273	275	230	241	4.8%
Maple Township	341	317	322	311	-3.4%
Nickerson Township	691	851	792	754	-4.8%
Village of Nickerson	291	431	368	312	-15.2%
City of North Bend	1,249	1,213	1,177	1,279	8.7%
PebbleTownship	532	528	489	418	-14.5%
Village of Snyder/Pebble	218	253	250	202	-19.2%
Platte Township	2,099	2,307	2,235	2,255	0.9%
Village of Inglewood	286	382	325	380	16.9%
Pleasant Valley Township	202	200	166	171	3.0%
Ridgeley Township	215	208	168	175	4.2%
City of Scribner	950	971	857	843	-1.6%
Union Township	262	233	253	244	-3.6%
WebsterTownship	1,070	1,002	886	856	-3.4%
Village of Dodge	693	700	612	611	-0.2%
Village of Snyder in Webster	62	65	50	52	4.0%
TOTAL DODGE COUNTY	34,500	36,160	36,691	37,167	1.3%

NEBRASKA COUNTIES PREFIX AUTO LICENSE NUMBERS and COUNTY SEATS

1 Douglas-Omaha	32 Thayer-Hebron	63 Boyd-Butte
2 Lancaster-Lincoln	33 Jefferson-Fairbury	64 Morrill-Bridgeport
3 Gage-Beatrice	34 Fillmore-Geneva	65 Box Butte-Alliance
4 Custer-Broken Bow	35 Dixon-Ponca	66 Cherry-Valentine
5 Dodge-Fremont	36 Holt-O'Neill	67 Hitchcock-Trenton
6 Saunders-Wahoo	37 Phelps-Holdrege	68 Keith-Ogallala
7 Madison-Madison	38 Furnas-Beaver City	69 Dawes-Chadron
8 Hall-Grand Island	39 Cheyenne-Sidney	70 Dakota-Dakota City
9 Buffalo-Kearney	40 Pierce, Pierce	71 Kimball-Kimball
10 Platte-Columbus	41 Polk-Osceola	72 Chase-Imperial
11 Otoe-Nebraska City	42 Nuckolls-Nelson	73 Gosper-Elwood
12 Knox-Center	43 Colfax-Schuyler	74 Perkins-Grant
13 Cedar-Hartington	44 Nemaha-Auburn	75 Brown-Ainsworth
14 Adams-Hastings	45 Webster-Red Cloud	76 Dundy-Benkelman
15 Lincoln-North Platte	46 Merrick-Central City	77 Garden-Oshkosh
16 Seward-Seward	47 Valley-Ord	78 Deuel-Chappell
17 York-York	48 Red Willow-McCook	79 Hayes-Hayes Center
18 Dawson-Lexington	49 Howard-St. Paul	80 Sioux-Harrison
19 Richardson-Falls City	50 Franklin-Franklin	81 Rock-Bassett
20 Cass-Plattsmouth	51 Harlan-Alma	82 Keya Paha-Springview
21 Scotts Bluff-Gering	52 Kearney-Minden	83 Garfield-Burwell
22 Saline-Wilber	53 Stanton-Stanton	84 Wheeler-Bartlett
23 Boone-Albion	54 Pawnee-Pawnee City	85 Banner-Harrisburg
24 Cuming-West Point	55 Thurston-Pender	86 Blaine-Brewster
25 Butler-David City	56 Sherman-Loup City	87 Logan-Stapleton
26 Antelope-Neligh	57 Johnson-Tecumseh	88 Loup-Taylor
27 Wayne, Wayne	58 Nance-Fullerton	89 Thomas-Thedford
28 Hamilton-Aurora	59 Sarpy-Papillion	90 McPherson-Tryon
29 Washington-Blair	60 Frontier-Stockville	91 Arthur-Arthur
30 Clay-Clay Center	61 Sheridan-Rushville	92 Grant-Hyannis
31 Burt-Tekamah	62 Greeley-Greeley	93 Hooker-Mullen

Table of Contents

County Flag (dedicated 03/15/2006)	Back Cover
Office Locations	Inside Front Cover
Introductory Remarks	1
County Officials & Board Directories (Quick Reference)	2-6
Meetings of County Board	7
Courthouse Hours & Holidays	8
City and Village Officials	9
Township Officials	10-11
Where To Go For	12-14
Time Capsule	14
Voter Information	15-17
Precinct Maps	18-21
Tax Section	22-43
Dodge County Budget	23-31
How to Figure Taxes	32-33
Itemized City Levies	34
City and Village Levies	35
Township Levies	36-37
Fire Protection District Levies	38-39
Other Levies	40-41
School District Levies	42-43
Census Information & Historical Facts	44
Nebraska Counties	Inside Back Cover

